

**HOSPITAL**  
**CONTAINER**



# HEALTHCARE CONTAINERS

[hospitalcontainer.com](http://hospitalcontainer.com)

# HOSPITAL CONTAINER

## About Us

As Hospital Container, the leading manufacturer of container-type healthcare units, we meticulously handle every detail. Established as a subsidiary of the ENAK company, Hospital Container aims to deliver healthcare solutions to hard-to-reach areas with our 31 years of experience in the healthcare sector and expert team.

We design and implement the planning of our products meticulously according to customer needs. We select the highest quality materials to ensure durability, efficiency, and safety in each of our productions. Every component undergoes rigorous quality control processes, meeting industry standards.

Furthermore, our emphasis on innovation is at the core of our business. We make significant investments in research and development, aiming to be at the forefront of healthcare technology. This forward-thinking approach allows us to anticipate and meet the evolving needs of healthcare providers and our customers.

Hospital Container specializes in converting shipping containers into complete, portable medical clinics. Each clinic is tailored to be customizable and arrives fully equipped to meet your unique needs.

### The Types of Healthcare Container We Produce

20Ft Healthcare Containers

40Ft Healthcare Containers

**Expandable** Containers

**Multi Complex** Healthcare Containers

**Hospital** Containers

**Customized** Containers





31 Years **Experience**

Leading **Manufacturer**

Customized **Product Design**

**Quality** Material Selection

**Rigorous** Quality Control

Customer **Satisfaction** Focus

Responsive **Solutions**

**Expert** Team



## Advantages of Utilizing Shipping Containers in Healthcare Clinics.

The use of standard containers in converted health cabins offers advantages such as portability, modular design, and cost-effectiveness. Standard containers, widely used in the international shipping industry, can be easily transported worldwide. Their modular structure allows for the quick design of health cabins in various dimensions and facilitates customization to meet specific needs.

Additionally, the widespread use of standard containers provides a cost-effective solution, reducing production costs for health cabins and presenting an economical option for healthcare organizations. Consequently, converted health cabins, with their quick installation, customization capabilities, and cost advantages, can contribute to extending healthcare services to broader populations.

### Standardization:

The shipping container adheres to the standards set by the International Organization for Standardization (ISO). This standardization allows for easy use across different transportation vehicles and logistics systems.

### Material:

Steel is typically the primary material used in the construction of the container. Its durability and resistance to corrosion contribute to a long lifespan.

### Modular Design:

Containers can be stacked and combined due to their modular structure, providing convenience during storage or transportation.

### Modes of Transport:

It can be utilized in sea, land, and rail transportation, making it widely applicable in global trade.

### Volume:

The shipping container offers ample volume suitable for transporting a wide variety of products and materials. Its spacious interior allows for organized loading.

### International Trade:

The shipping containers are widely preferred in international trade as a standard transport unit used worldwide.

# Our Highlighted Features



## Efficient Space Utilization

We prepare a floor plan to efficiently utilize the interior space of the containers and design a seamless working environment. The structural walls of the clinics are robust enough to support all medical equipment and storage cabinets. Mounting equipment on the walls instead of the floor allows us to keep the floor space clean and organized, further facilitating the cleaning process.

## Portability

Container healthcare clinics can be easily shipped to any point worldwide and set up rapidly due to their modular designs. This feature provides a significant advantage, particularly in emergency interventions, disaster relief efforts, or situations requiring healthcare services in remote areas.

Container healthcare clinics can also serve as a temporary health unit during hospital renovation projects. In such cases, these clinics ensure uninterrupted access to healthcare services for patients with their functionality and portability.





### **Durability and Sustainability:**

Our clinics are manufactured from steel shipping containers, and their robust structure provides exceptional durability against various threats such as extreme weather conditions, earthquakes, and challenging terrains. This feature ensures the longevity and continuity of use for the clinics.

Additionally, incorporating recycled materials into our production process reflects our commitment to sustainability principles. This approach allows us to produce high-quality and durable clinics while minimizing environmental impact.



### **Advanced Hygiene Control:**

The floors are covered with materials that meet hygiene standards and are easy to clean. The walls, with their robust structures, not only support clinical equipment but also facilitate the cleaning processes. Electrical outlets ensure safe and organized energy distribution, while cabinets make it easy to store materials in an organized manner.

All these design elements not only ensure the effective operation of the clinic but also prioritize patient safety and hygiene standards. Thus, users have the opportunity to work in a safe, clean, and comfortable environment.



20FT CONTAINER

# MEDICAL CLINIC

[hospitalcontainer.com](http://hospitalcontainer.com)

**HOSPITAL**  
CONTAINER

# MEDICAL CLINIC



## 20ft Medical Clinic

Our clinic container offers a specially designed compact unit to meet modern medical needs. It is equipped with a fully-furnished examination area, a sterilization unit, and basic health screening equipment. This makes it an ideal solution for providing a range of healthcare services, from emergency interventions to routine check-ups.

Our clinic container can be quickly set up wherever needed. It is perfect for delivering services rapidly in disaster areas, rural areas, or temporary health centers. Its easy portability enhances accessibility, allowing communities to gain faster access to healthcare services.

Designed in compliance with health standards, our clinic container incorporates modern sterilization techniques to ensure the highest levels of hygiene. This maximizes the safety and health of your patients.

Our clinic container is designed with environmental considerations in mind. By using high-quality materials to enhance durability and ensuring energy efficiency, it promotes long-lasting solutions and encourages sustainability.



## MEDICAL CLINIC



## MEDICAL CLINIC Specifications

### WALLS

**WALL INSULATION** After interior insulation, walls are covered with panels featuring antibacterial properties, either with PVC or aluminum surfaces.

### FLOOR

**FLOOR COATING** 2 mm thick PVC vinyl are used on 14 mm thick board or epoxy coating.

### DOORS

**EXTERNAL / INTERNAL DOOR** The interior and exterior doors of the container can be manufactured from PVC, Aluminum, and Metal materials.

### WINDOWS

**WINDOW** The windows of the container can be manufactured from PVC, Aluminum, and Metal materials. Windows can be single or double-winged and can open up to 90 degrees.

**GLASS** It can be a double glazed window.

### ELECTRIC INSTALLATIONS

**LIGHTING** A moisture-proof luminaire is used.

**PLUGS** Socket - 12V-Inverter (Optional) - Duplex electrical outlet 220V (Optional)

## MEDICAL CLINIC Equipment List

The list below includes the basic furnishing products and medical supplies for a container unit. Every unit may have different needs, so this list should be adapted according to specific clinic requirements.

### EQUIPMENTS

Item	Item Code	QTY
Office First Aid Aid Kit	P7775964	1
Diagnostic Kit	P7774093	1
Glove Dispenser	7143865	1
Nitrile Gloves, Size S (Box of 100)	5810227	10
Nitrile Gloves, Size M (Box of 100)	5810228	10
Nitrile Gloves, Size L (Box of 100)	5810229	10
Disinfection/Soap Dispenser (Touchless)	7120766	2
Hand disinfection 1.000ml	5950040	5
Hand soap 1.000ml	7145852	5
Face mask FFP2	5810219	100
Towel Dispenser	5520065	1
Towel (3.200 each)	7052066	1
Garbage can, steel, with foot operated lid	7119528	1
Defibrillator	P7773996	1
Ultrasound Unit	P7786206	1
Notebook	7742237UK	1
Printer	7704065	1
Foldable Stretcher	7201342	1

### INTERIOR MATERIALS

Reception Area:	WC:	Examination Area:
Reception Desk	Sink	3-double cabinets
Reception Chair	Toilet	Sink
Three-door cabinet		Examination Bed
		Doctor's desk
		Doctor's stool
		Medicine cabinet

# MEDICAL CLINIC Dimensions

## 20ft CONTAINER DIMENSIONS:

**Exterior Dimensions / Area** 6,058 × 2,438 × 2,591 mm / 20' x 8' x 8' 6" / 13.93 m<sup>2</sup>  
L × W × H

**Interior Dimensions / Area** 5,898 × 2,340 × 2,390 mm / 20' x 8' x 8' 6" / 28.33 m<sup>2</sup>  
L × W × H

**Door Dimensions** W × H / 2.34 m x 2.28 m / 7 ft 9 in x 7 ft 6 in

**Volume** 33.2 cubic meters / 1,172 cubic feet

**Weight** It has a tare weight of 5,070 lbs. (2300 kg), a maximum payload weight (max cargo weight) of 55,126.9 lbs. (25,000 kg), and a maximum gross weight of 60,197 lbs. (27,305 kg).

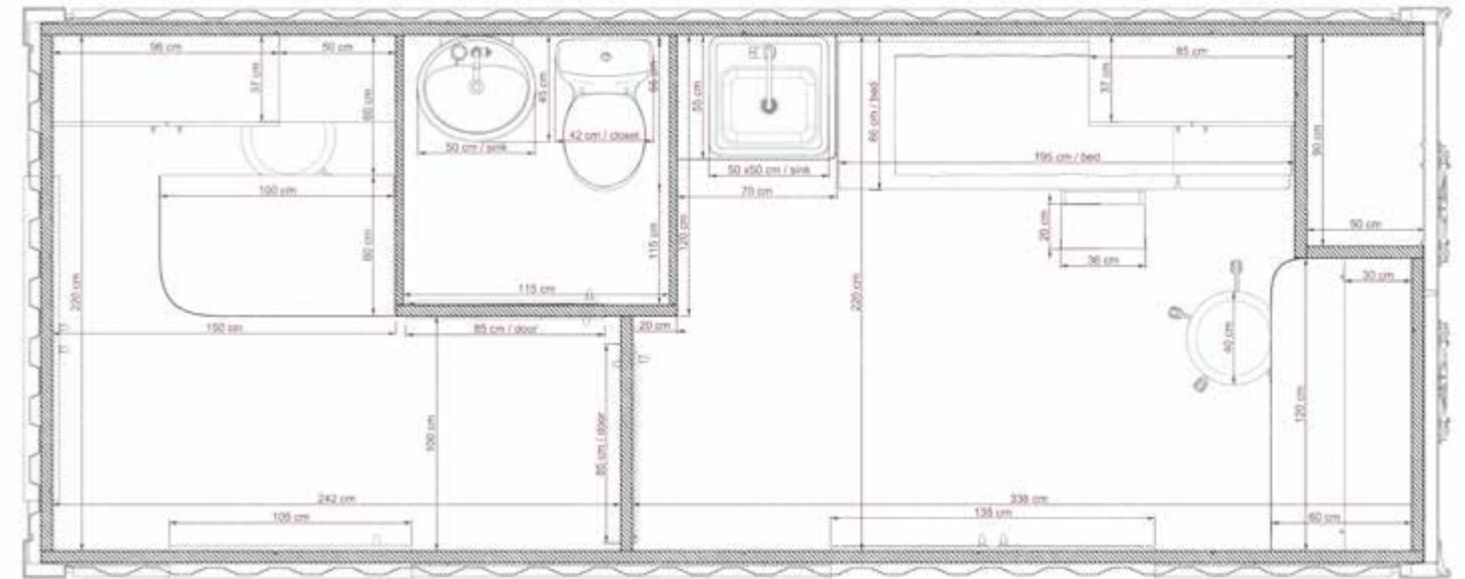

## Front View

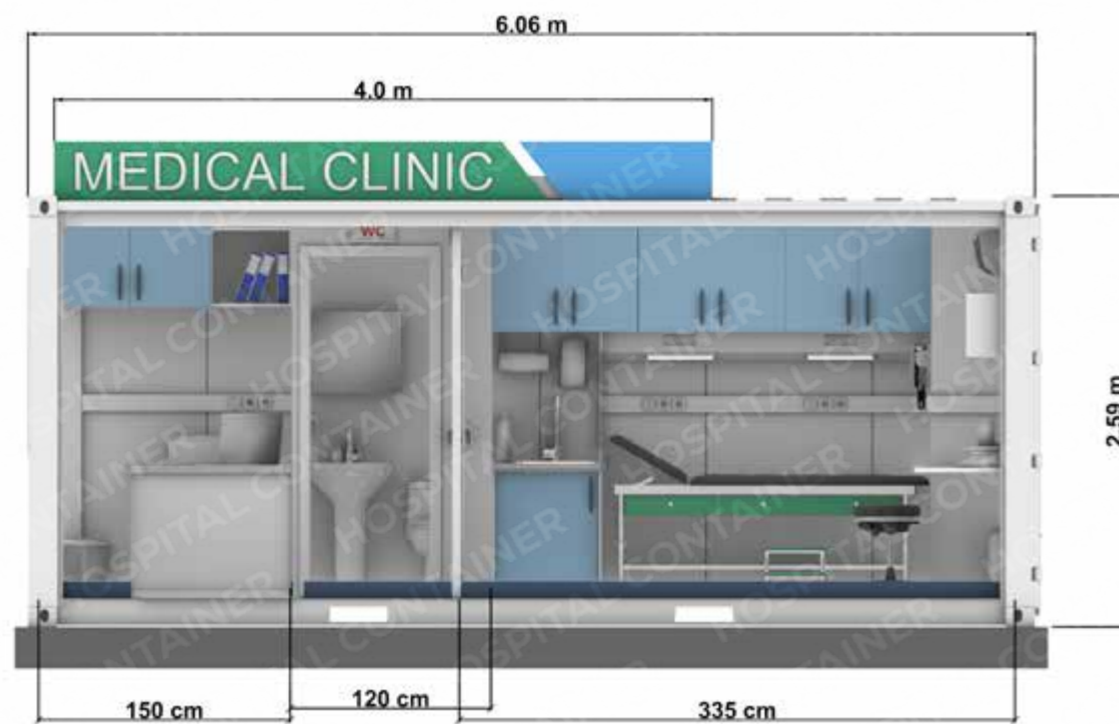

## Top View

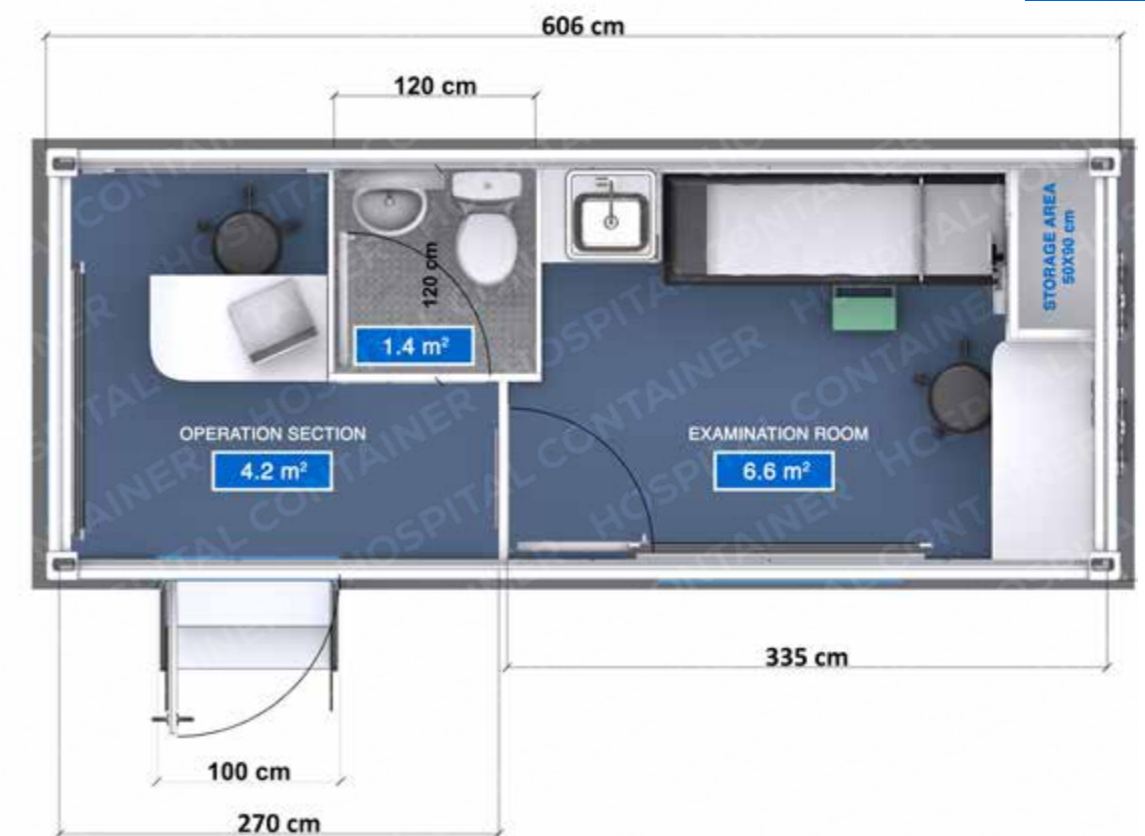

## MEDICAL CLINIC Interior Design

The operator section located in the entrance area is where patient records are maintained. Depending on customer requests, a waiting area may also be included in this section. A restroom has been incorporated into this area for the convenience of healthcare staff and patients. Additionally, a double-wing PVC window is installed in this section, and upon request, a blind system can be added to these windows. In accordance with safety standards, an exit sign indicating the way out can be mounted on the ceiling in this section. Similarly, signage and informational panels can be added inside the space. The electrical panel and system equipment, where the electrical system is gathered and controlled, are placed inside the cabinet behind the operator desk.

Depending on the conditions of the land where the container will be positioned and the height of the entrance door from the ground, an optional exit staircase can be added. Advertising panels, logos, or emblems requested can be added to the exterior of the container according to the order.



You can visit the this container  
by scanning the QR code.



## MEDICAL CLINIC Interior Design

The examination room is designed to be utilized by healthcare personnel in the most effective and efficient manner. The sink area, situated next to the examination bed, is positioned for the convenient use of both the staff and the patient. The plexiglass separator next to the sink is designed to separate the sink from the patient bed. The cabinet below the sink and the three double-door cabinets in the upper section provide a suitable arrangement for storing and organizing the personnel needs in the examination room.

The examination table is illuminated with LED lighting located under the cabinets. A simple step ladder is located under the standard-sized examination table for the comfort of patients. Depending on customer preferences, an otoscope-ophthalmoscope-blood pressure monitor set can also be wall-mounted above the examination bed. There are three 220V outlets in the room.

At the entrance of the examination room, there is a doctor's desk and a stool. On the desk, there is a pharmacy cabinet. Optionally, an air conditioner can be mounted on top of this section.





20FT CONTAINER  
**X-RAY UNIT**

[hospitalcontainer.com](http://hospitalcontainer.com)

**HOSPITAL**  
**CONTAINER**



## 20ft Xray Unit

Container X-ray Units are innovative mobile health solutions that enable the deployment of advanced medical imaging technology to the most remote areas. These specialized units are equipped with state-of-the-art radiology equipment.

Each Container X-ray Unit is furnished with cutting-edge X-ray machines and related equipment. This allows for the acquisition of sharp and high-resolution images, enabling accurate diagnoses to be made.

Container X-ray Units provide a significant advantage, especially in remote or hard-to-reach areas, emergency interventions, and disaster situations. Thanks to their mobile structure, they can be swiftly transported to wherever they are needed.

Facilitating the delivery of modern medicine to your doorstep, Container X-ray Units enhance access to uninterrupted healthcare services, ultimately strengthening public health.



## X-RAY UNIT

## XRAY UNIT Equipment List

## X-RAY UNIT Specifications

### WALLS

**WALL INSULATION** After interior insulation, walls are covered with panels featuring antibacterial properties, either with PVC or aluminum surfaces.

### FLOOR

**FLOOR COATING** 2 mm thick PVC vinyl are used on 14 mm thick board or epoxy coating.

### DOORS

**EXTERNAL / INTERNAL DOOR** The interior and exterior doors of the container can be manufactured from PVC, Aluminum, and Metal materials.

### WINDOWS

**WINDOW** The windows of the container can be manufactured from PVC, Aluminum, and Metal materials. Windows can be single or double-winged and can open up to 90 degrees.

**GLASS** It can be a double glazed window.

### ELECTRIC INSTALLATIONS

**LIGHTING** A moisture-proof luminaire is used.

**PLUGS** Socket - 12V-Inverter (Optional) - Duplex electrical outlet 220V (Optional)

The list below includes the basic furnishing products and medical supplies for a container clinic. Every clinic may have different needs, so this list should be adapted according to specific clinic requirements.

### EQUIPMENTS

Item	Item Code	QTY
Office First Aid Aid Kit	P7775964	1
Diagnostic Kit	P7774093	1
Glove Dispenser	7143865	1
Nitrile Gloves, Size S (Box of 100)	5810227	10
Nitrile Gloves, Size M (Box of 100)	5810228	10
Nitrile Gloves, Size L (Box of 100)	5810229	10
Disinfection/Soap Dispenser (Touchless)	7120766	2
Hand disinfection 1.000ml	5950040	5
Hand soap 1.000ml	7145852	5
Face mask FFP2	5810219	100
Towel Dispenser	5520065	1
Towel (3.200 each)	7052066	1
Garbage can, steel, with foot operated lid	7119528	1
X-Ray Set	P7780594	1
UV Gerät	7778118	1
VM Kit	P7777848	1

### INTERIOR MATERIALS

#### Reception Area:

Reception Desk

Reception Chair

Waiting chair

#### Operator Area:

2 x Double-door base cabinet

Sink / Faucet

3 x Double-door upper cabinet

Operator Chair

Operator Desk





XRAY UNIT

# Interior Design

The reception desk in the entrance area divides the container into a waiting area and an x-ray section. The seating area in the waiting area is an optional feature and can be customized according to customer requests and needs. Waiting chairs, benches, and seats can be positioned as desired. In the x-ray section, there is an x-ray machine, operator's desk, and a counter and sink for staff use. This section also has a window through which the operator can see the x-ray room.

In the operator's section, there is a workbench and sufficient cabinets for storage underneath the bench. Additionally, there can be a refrigerator under the bench for storing medications and materials that require storage below a certain temperature. Depending on customer demands, necessary equipment and devices can be placed inside the container.



You can visit the this container by scanning the QR code.





20FT CONTAINER

# DENTAL CLINIC

[hospitalcontainer.com](http://hospitalcontainer.com)

**HOSPITAL**  
**CONTAINER**

# DENTAL CLINIC



## 20ft Dental Clinic

Conceived as a revolutionary mobile healthcare solution, our state-of-the-art container dental clinic is dedicated to extending contemporary dental services far and wide. It is meticulously designed and specially equipped to address the dynamic and diverse medical needs of the present era.

Our container dental clinic is not just a facility; it's a comprehensive healthcare provider offering a spectrum of services ranging from emergency interventions to routine dental care. With cutting-edge technology and a team of seasoned professionals, we ensure efficient, prompt, and top-notch solutions for all your dental needs.

Adhering to the highest health standards, our clinic incorporates modern sterilization techniques to guarantee impeccable levels of hygiene. This unwavering commitment to cleanliness and safety is paramount in enhancing the overall well-being of your patients.

The versatility of our container dental clinic knows no bounds. It can be swiftly deployed wherever the need arises, be it in rural communities or bustling city centers, at special events or during emergency interventions.

# DENTAL CLINIC Equipment List



## DENTAL CLINIC Specifications

### WALLS

**WALL INSULATION** After interior insulation, walls are covered with panels featuring antibacterial properties, either with PVC or aluminum surfaces.

### FLOOR

**FLOOR COATING** 2 mm thick PVC vinyl are used on 14 mm thick board or epoxy coating.

### DOORS

**EXTERNAL / INTERNAL DOOR** The interior and exterior doors of the container can be manufactured from PVC, Aluminum, and Metal materials.

### WINDOWS

**WINDOW** The windows of the container can be manufactured from PVC, Aluminum, and Metal materials. Windows can be single or double-winged and can open up to 90 degrees.

**GLASS** It can be a double glazed window.

### ELECTRIC INSTALLATIONS

**LIGHTING** A moisture-proof luminaire is used.

**PLUGS** Socket - 12V-Inverter (Optional) - Duplex electrical outlet 220V (Optional)

The list below includes the basic furnishing products and medical supplies for a container clinic. Every clinic may have different needs, so this list should be adapted according to specific clinic requirements.

### EQUIPMENTS

Item	Item Code	QTY
Office First Aid Aid Kit	P7775964	1
Diagnostic Kit	P7774093	1
Glove Dispenser	7143865	1
Nitrile Gloves, Size S (Box of 100)	5810227	10
Nitrile Gloves, Size M (Box of 100)	5810228	10
Nitrile Gloves, Size L (Box of 100)	5810229	10
Disinfection/Soap Dispenser (Touchless)	7120766	2
Hand disinfection 1.000ml	5950040	5
Hand soap 1.000ml	7145852	5
Face mask FFP2	5810219	100
Towel Dispenser	5520065	1
Towel (3.200 each)	7052066	1
Garbage can, steel, with foot operated lid	7119528	1
Air Compressor, Dental		1
Amalgamator, Digital High Speed, Dental		1
Apex locator		1
Dental console with triple syringe and dental instrument arm/mobile cart		1
Dental chair, electrical with cuspidor (Digital System) and Operating light		1
Dental Operatory Light, wall mounted		1
Dental, Ultrasonic scaler with disposable tips and accessories		1
Dental, X-ray, Intra-oral		1
Dental, Ultra-violet curing light equipment		1

### INTERIOR MATERIALS

#### Entrance Area:

Reception Desk  
Reception Chair

#### Examination Area:

1x Base cabinet  
Sink / Faucet  
Medicine Cabinet  
2 x Countertop  
5 x Upper cabinet  
3 x Base cabinet  
5-drawer module

# DENTAL CLINIC Dimensions

## 20ft CONTAINER DIMENSIONS:

**Exterior Dimensions / Area** 6,058 x 2,438 x 2,591 mm / 20' x 8' x 8' 6" / 13.93 m<sup>2</sup>  
L x W x H

**Interior Dimensions / Area** 5,898 x 2,340 x 2,390 mm / 20' x 8' x 8' 6" / 28.33 m<sup>2</sup>  
L x W x H

**Door Dimensions** W x H / 2.34 m x 2.28 m / 7 ft 9 in x 7 ft 6 in

**Volume** 33.2 cubic meters / 1,172 cubic feet

**Weight** It has a tare weight of 5,070 lbs. (2300 kg), a maximum payload weight (max cargo weight) of 55,126.9 lbs. (25,000 kg), and a maximum gross weight of 60,197 lbs. (27,305 kg).

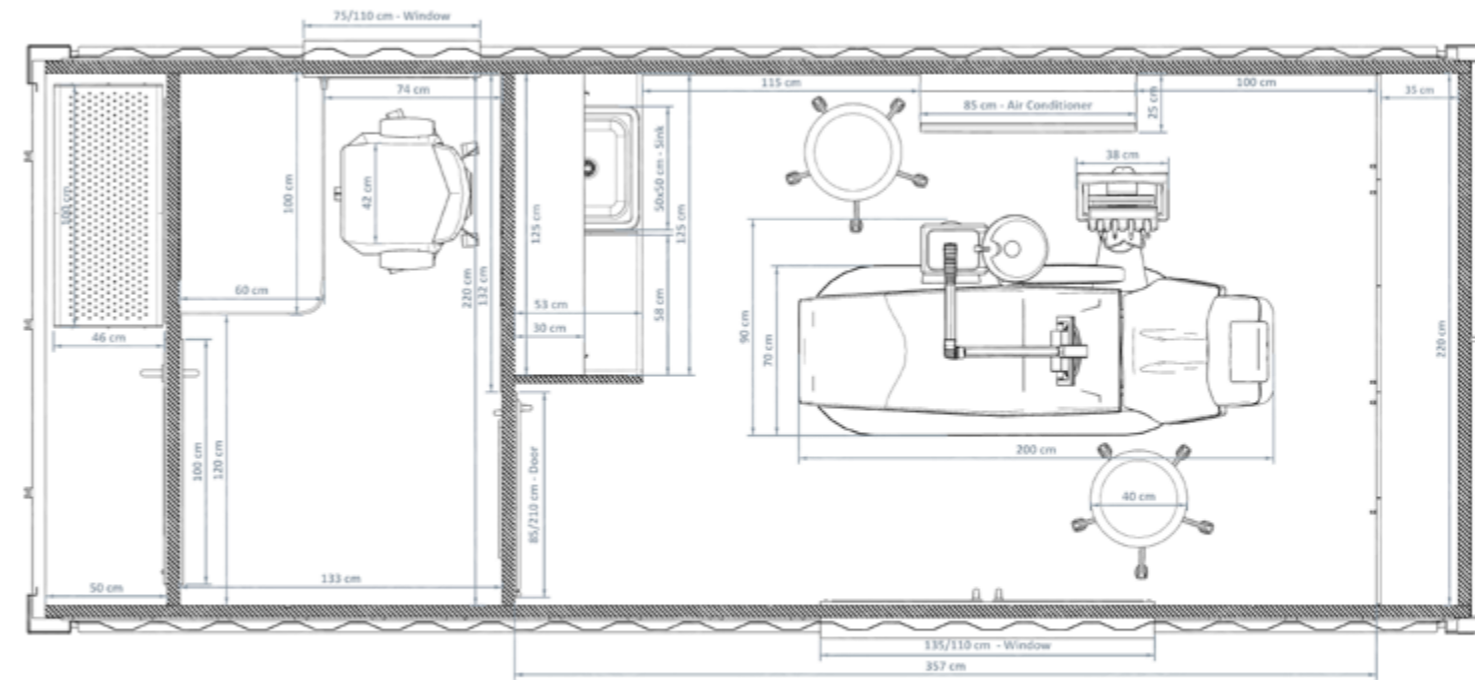

## Front View

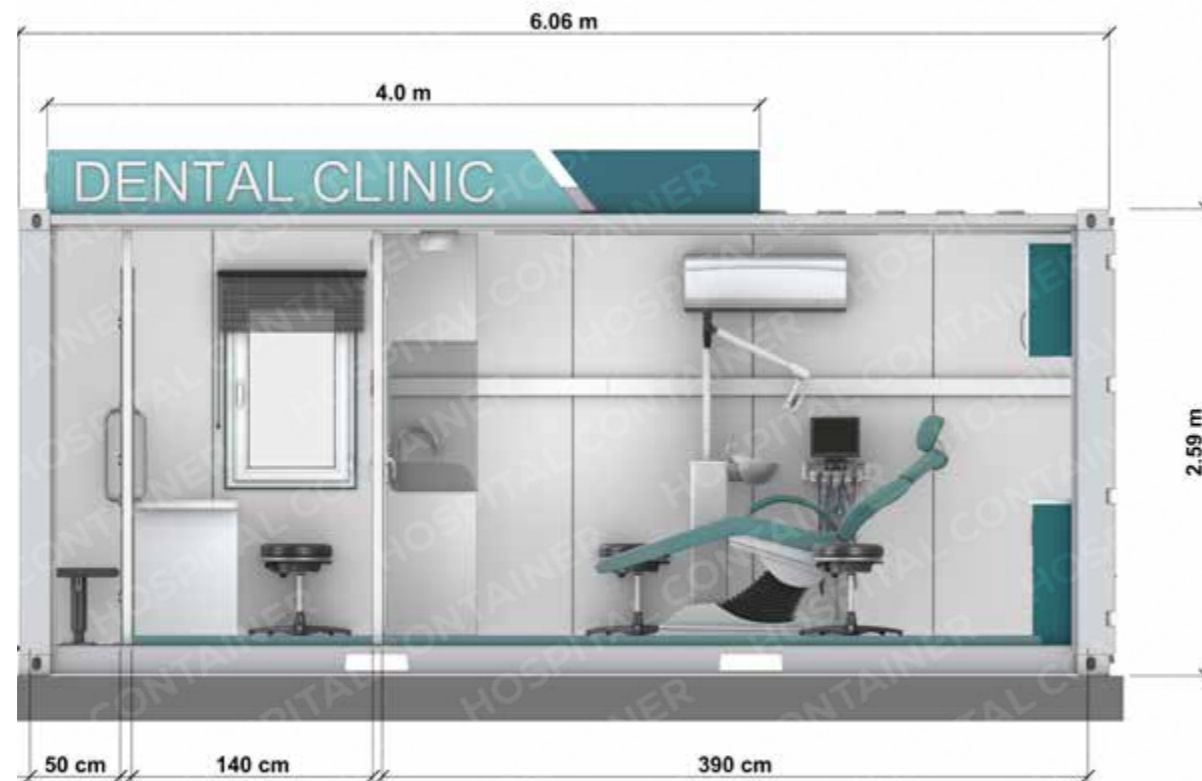

## Top View

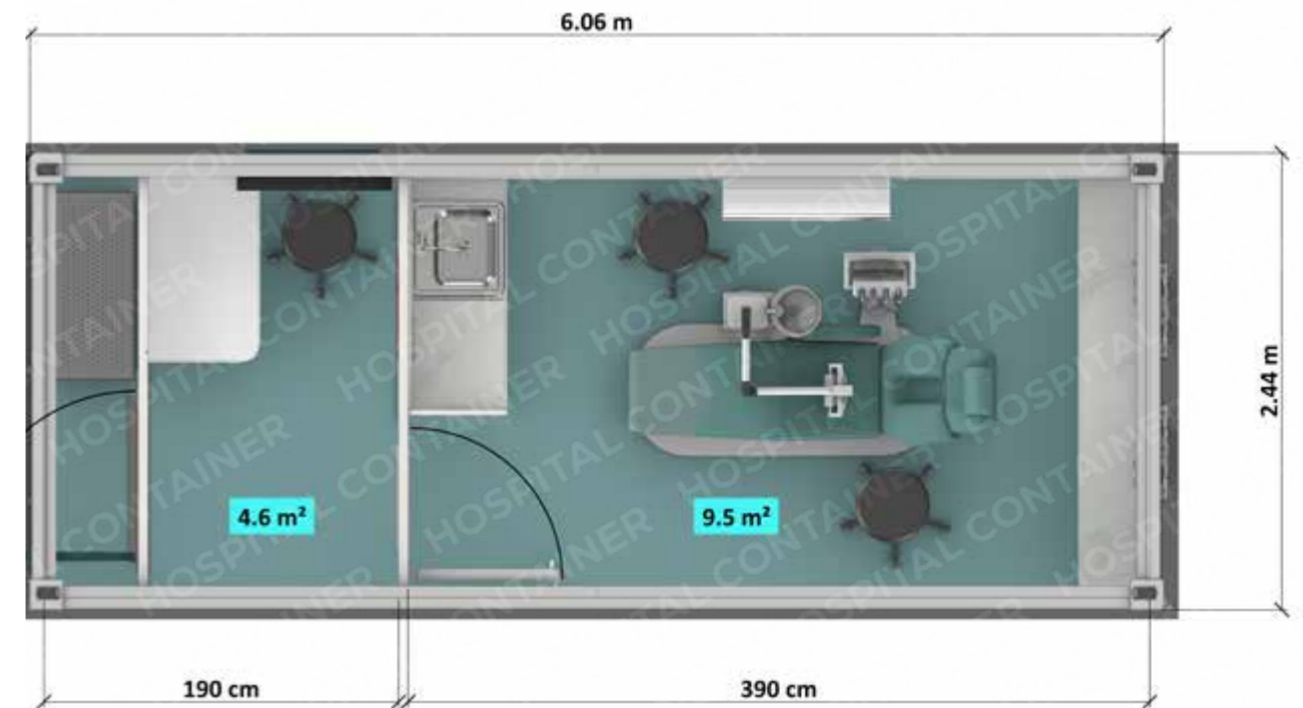

## DENTAL CLINIC / ENTERANCE

# Interior Design

At the entrance of the dental container, there is an operator section. In this area, there is a desk for the operator to manage patient records and provide consultation. Additionally, there is a PVC window for lighting and ventilation in this section. Access to the examination room is provided through the door in this area.

To use the container space more efficiently, less space is allocated to the entrance area. A spacious area is dedicated to the dental clinic section. In this examination room, a dental chair is centrally positioned to allow staff to move in a large area during examinations. Numerous cabinets are available for the storage of materials and equipment within the clinic. A worktable behind the chair facilitates the work of the personnel. A second worktable at the entrance allows the sink to be used by both patients and staff.



You can visit the this container by scanning the QR code.



## DENTAL CLINIC Interior Design

Under the sink, there is a cabinet that houses the water system. In this area, a refrigerator is available for medications or materials that need to be stored at a specific temperature in the dental clinic.

In the room, there are double-opening PVC windows for ventilation and lighting. Upon customer request, a blinds system can be integrated into these windows.

Cabinet modules behind the chair provide both storage and workspace for the equipment and materials required in the dental clinic. These cabinet modules can be made with antibacterial features in wood or aluminum coating according to customer preferences.

The electrical system needed for the clinic can be provided with a solar panel system, hybrid electrical system, or generator. The clean water and wastewater system can be integrated into the container system based on the location where the container will be placed.





20FT CONTAINER

# PHARMACY UNIT

[hospitalcontainer.com](http://hospitalcontainer.com)

**HOSPI+AL**  
**CONTAINER**





## 20ft Pharmacy Unit

Container Pharmacy is a portable healthcare unit designed to meet urgent medical needs and provide temporary health services. This specialized container is equipped with modern medical equipment and is designed to ensure rapid intervention in emergency situations.

Container pharmacies play a crucial role in disaster areas or areas with limited accessibility. Especially in cases of natural disasters, conflicts, or other emergencies where traditional healthcare infrastructure may be limited or unusable, these mobile pharmacies offer a fast and effective solution. Each Container Pharmacy can be customized according to the needs of

patients. The aim is to stock these containers with medications, medical supplies, and other healthcare products for the quick management of emergencies. Additionally, these pharmacies may include workspaces for healthcare personnel and essential medical equipment.

Thanks to their portable structures, Container Pharmacies can be easily transported to any required location. This allows for their rapid deployment and service during emergencies. Moreover, these pharmacies can also be used for community events, campaigns, or other activities requiring temporary healthcare services.



## PHARMACY UNIT Equipment List

## PHARMACY UNIT Specifications

### WALLS

**WALL INSULATION** After interior insulation, walls are covered with panels featuring antibacterial properties, either with PVC or aluminum surfaces.

### FLOOR

**FLOOR COATING** 2 mm thick PVC vinyl are used on 14 mm thick board or epoxy coating.

### DOORS

**EXTERNAL / INTERNAL DOOR** The interior and exterior doors of the container can be manufactured from PVC, Aluminum, and Metal materials.

### WINDOWS

**WINDOW** The windows of the container can be manufactured from PVC, Aluminum, and Metal materials. Windows can be single or double-winged and can open up to 90 degrees.

**GLASS** It can be a double glazed window.

### ELECTRIC INSTALLATIONS

**LIGHTING** A moisture-proof luminaire is used.

**PLUGS** Socket - 12V-Inverter (Optional) - Duplex electrical outlet 220V (Optional)

The list below includes the basic furnishing products and medical supplies for a container clinic. Every clinic may have different needs, so this list should be adapted according to specific clinic requirements.

### EQUIPMENTS

Item	Item Code	QTY
Office First Aid Aid Kit	P7775964	1
Diagnostic Kit	P7774093	1
Glove Dispenser	7143865	1
Nitrile Gloves, Size S (Box of 100)	5810227	10
Nitrile Gloves, Size M (Box of 100)	5810228	10
Nitrile Gloves, Size L (Box of 100)	5810229	10
Disinfection/Soap Dispenser (Touchless)	7120766	2
Hand disinfection 1.000ml	5950040	5
Hand soap 1.000ml	7145852	5
Face mask FFP2	5810219	100
Towel Dispenser	5520065	1
Towel (3.200 each)	7052066	1
Garbage can, steel, with foot operated lid	7119528	1

### INTERIOR MATERIALS

#### Entrance Area:

3-seater waiting chair

#### Pharmacy Area:

3 x Double-door base cabinet

5-Drawer module

5 x Upper cabinet

2 x Glass-fronted medicine cabinets

Countertop

Sink / Faucet

Desk

Chair

# PHARMACY UNIT Dimensions

## 20ft CONTAINER DIMENSIONS:

**Exterior Dimensions / Area** 6,058 × 2,438 × 2,591 mm / 20' x 8' x 8' 6" / 13.93 m<sup>2</sup>  
L × W × H

**Interior Dimensions / Area** 5,898 × 2,340 × 2,390 mm / 20' x 8' x 8' 6" / 28.33 m<sup>2</sup>  
L × W × H

**Door Dimensions** W × H / 2.34 m x 2.28 m / 7 ft 9 in x 7 ft 6 in

**Volume** 33.2 cubic meters / 1,172 cubic feet

**Weight** It has a tare weight of 5,070 lbs. (2300 kg), a maximum payload weight (max cargo weight) of 55,126.9 lbs. (25,000 kg), and a maximum gross weight of 60,197 lbs. (27,305 kg).

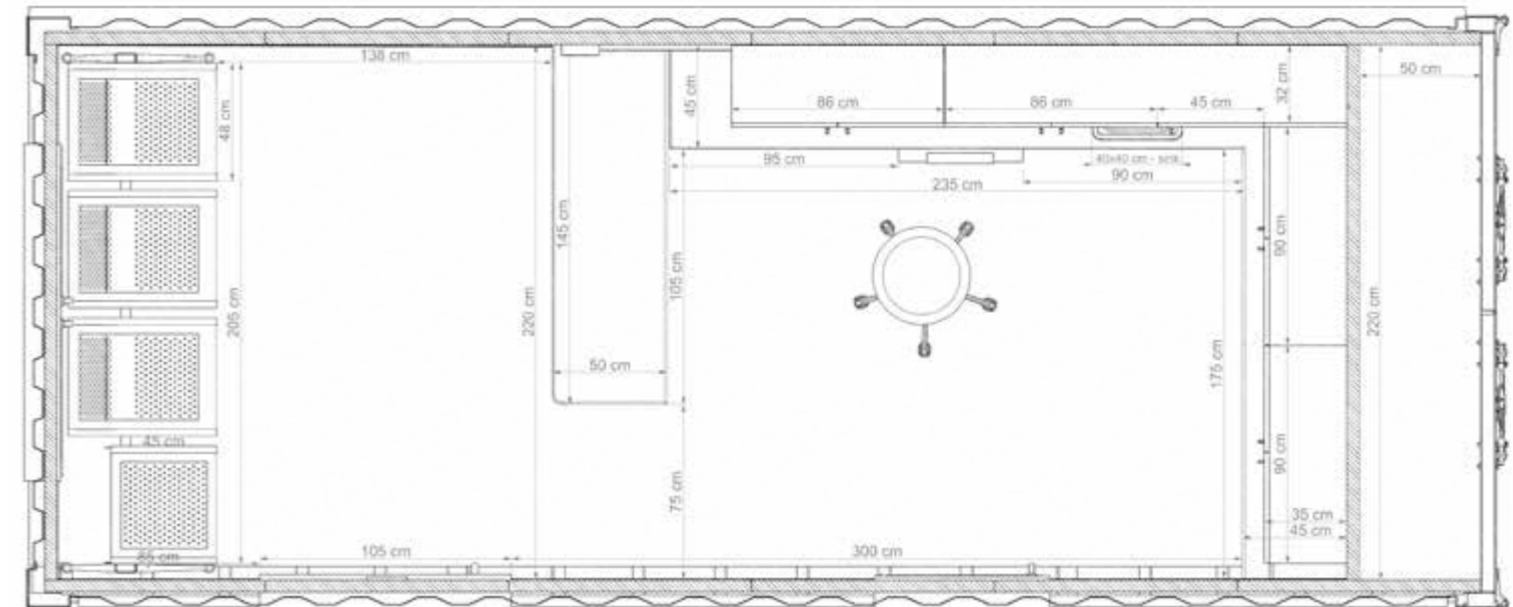

## Front View

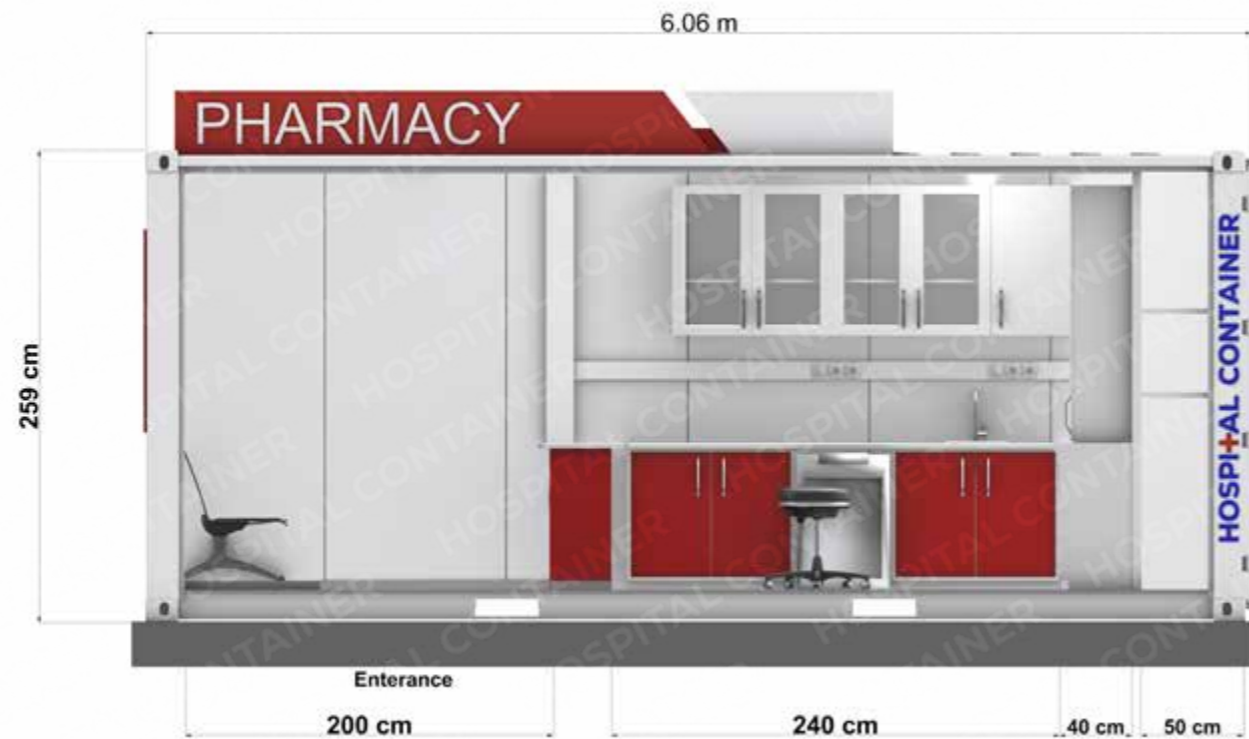

## Top View



## PHARMACY UNIT

# Interior Design

The reception desk in the entrance area divides the container into a waiting area and a pharmacy section. The metal bench located in the waiting area is an optional feature that can be customized according to customer requests and needs. Waiting chairs, benches, and chairs can be positioned as desired. In the pharmacy section, there is initially a reception desk where staff provides services to visitors. Two glass-fronted cabinets are located in the rear for storing pharmacy products and medications. These cabinets have a drawer module to facilitate storage and organization.

In the pharmacy section, there is a workbench, and there are sufficient cabinets for storage underneath the bench. Additionally, there is a refrigerator under the bench for storing medications and materials that require storage below a certain temperature. Depending on customer demands, the storage area near the container's doors can be customized to serve as a cold room.



You can visit the this container by scanning the QR code.





20FT CONTAINER

# LABORATORY UNIT

[hospitalcontainer.com](http://hospitalcontainer.com)

**HOSPITAL**  
**CONTAINER**



## 20ft Laboratory Unit

Container laboratories are first-class portable healthcare solutions that enable the transfer of cutting-edge medical technology to the most inaccessible geographies. These unique laboratories are portable units equipped with state-of-the-art analysis equipment.

Each Container Laboratory is equipped with the most advanced analytical devices and relevant laboratory equipment. This allows for accurate diagnoses based on reliable data obtained

from meticulously conducted tests. Container Laboratories offer significant advantages, especially in remote areas with challenging access, emergency interventions, and disaster situations. Thanks to their mobile structure, these laboratories can be rapidly transported to any needed location.

Container laboratories, as adaptable healthcare solutions, have proven instrumental in various applications, addressing critical needs in challenging environments. Here is an expanded exploration of their utilization in diverse scenarios:

### **Areas with Challenging Access:**

*In remote or geographically isolated regions where traditional healthcare services struggle to reach, container laboratories serve as beacons of accessible medical support. These areas often lack permanent healthcare infrastructure, making the mobility of these labs essential for ensuring timely and effective diagnostic and treatment services.*

### **Emergency Interventions:**

*The agility of container laboratories becomes paramount during emergencies, such as natural disasters or accidents. Their rapid deployment capability allows for on-site diagnostics, aiding in the swift provision of healthcare services where conventional facilities may be incapacitated.*

### **Research and Field Work:**

*Beyond diagnostics, mobile laboratories support researchers in conducting fieldwork. They serve as on-the-go hubs equipped with advanced analytical tools, facilitating scientific studies, sample analyses, and data collection in diverse environments.*

### **Health Screening Camps:**

*Container laboratories are indispensable in health screening camps, offering swift and accurate diagnostics. These temporary medical camps, often set up in response to specific health concerns or outbreaks, benefit from the mobility and comprehensive capabilities of these labs.*

### **Prisons and Immigration Centers:**

*Confined spaces like prisons and immigration centers can leverage container laboratories to optimize medical service delivery. These portable units streamline health assessments, ensuring that individuals in these settings receive necessary healthcare without compromising safety or efficiency.*

### **Rural Health Centers:**

*Container laboratories contribute significantly to the delivery of basic healthcare services in rural areas. Their mobility is particularly advantageous in reaching remote villages and communities, providing diagnostic capabilities that might otherwise be unavailable.*

### **Military Operations and Field Hospitals:**

*Portable laboratories play a pivotal role in supporting military operations and field hospitals. They are adaptable to the dynamic and challenging environments of war zones, offering crucial diagnostic and medical support to military personnel and civilians affected by conflict.*





## LABORATORY UNIT Equipment List

The list below includes the basic furnishing products and medical supplies for a container clinic. Every clinic may have different needs, so this list should be adapted according to specific clinic requirements.

## LABORATORY UNIT Specifications

### WALLS

**WALL INSULATION** After interior insulation, walls are covered with panels featuring antibacterial properties, either with PVC or aluminum surfaces.

### FLOOR

**FLOOR COATING** 2 mm thick PVC vinyl are used on 14 mm thick board or epoxy coating.

### DOORS

**EXTERNAL / INTERNAL DOOR** The interior and exterior doors of the container can be manufactured from PVC, Aluminum, and Metal materials.

### WINDOWS

**WINDOW** The windows of the container can be manufactured from PVC, Aluminum, and Metal materials. Windows can be single or double-winged and can open up to 90 degrees.

**GLASS** It can be a double glazed window.

### ELECTRIC INSTALLATIONS

**LIGHTING** A moisture-proof luminaire is used.

**PLUGS** Socket - 12V-Inverter (Optional) - Duplex electrical outlet 220V (Optional)

### EQUIPMENTS

Item	Item Code	QTY
Office First Aid Aid Kit	P7775964	1
Diagnostic Kit	P7774093	1
Glove Dispenser	7143865	1
Nitrile Gloves, Size S (Box of 100)	5810227	10
Nitrile Gloves, Size M (Box of 100)	5810228	10
Nitrile Gloves, Size L (Box of 100)	5810229	10
Disinfection/Soap Dispenser (Touchless)	7120766	2
Hand disinfection 1.000ml	5950040	5
Hand soap 1.000ml	7145852	5
Face mask FFP2	5810219	100
Towel Dispenser	5520065	1
Towel (3.200 each)	7052066	1
Garbage can, steel, with foot operated lid	7119528	1
Accessory Kit for mobile lab	P7777848	1
Trinocular Oxion microscope	7782837	1
Centrifuge EBA20	7770483	1
Blood glucose meter incl. Consumables	P7783443	1
HemoCue Haemoglobin HB201+ Analyzer incl. Cuvettes	7308090	1
Advia 560 Haematology Analyzer		1
Clinical-chemical analyser, Spotchem EZ SP-4430 incl accessories	7321458	1
Refrigerator	7778814	1

### INTERIOR MATERIALS

Reception Area:	Laboratory Area:	Cold Storage Area:
Reception Desk	2 x Double-door base cabinet	2 shelves
Reception Chair	5-drawer module	
5-drawer module	U-shaped countertop	
2 shelves	Sink / Faucet	
Double-door upper cabinet	5 x Double-door upper cabinet	
	Shelf with 4 sections	
	3 x Chair	



# LABORATORY UNIT Dimensions

## 20ft CONTAINER DIMENSIONS:

**Exterior Dimensions / Area** 6,058 × 2,438 × 2,591 mm / 20' x 8' x 8' 6" / 13.93 m<sup>2</sup>  
L × W × H

**Interior Dimensions / Area** 5,898 × 2,340 × 2,390 mm / 20' x 8' x 8' 6" / 28.33 m<sup>2</sup>  
L × W × H

**Door Dimensions** W × H / 2.34 m x 2.28 m / 7 ft 9 in x 7 ft 6 in

**Volume** 33.2 cubic meters / 1,172 cubic feet

**Weight** It has a tare weight of 5,070 lbs. (2300 kg), a maximum payload weight (max cargo weight) of 55,126.9 lbs. (25,000 kg), and a maximum gross weight of 60,197 lbs. (27,305 kg).

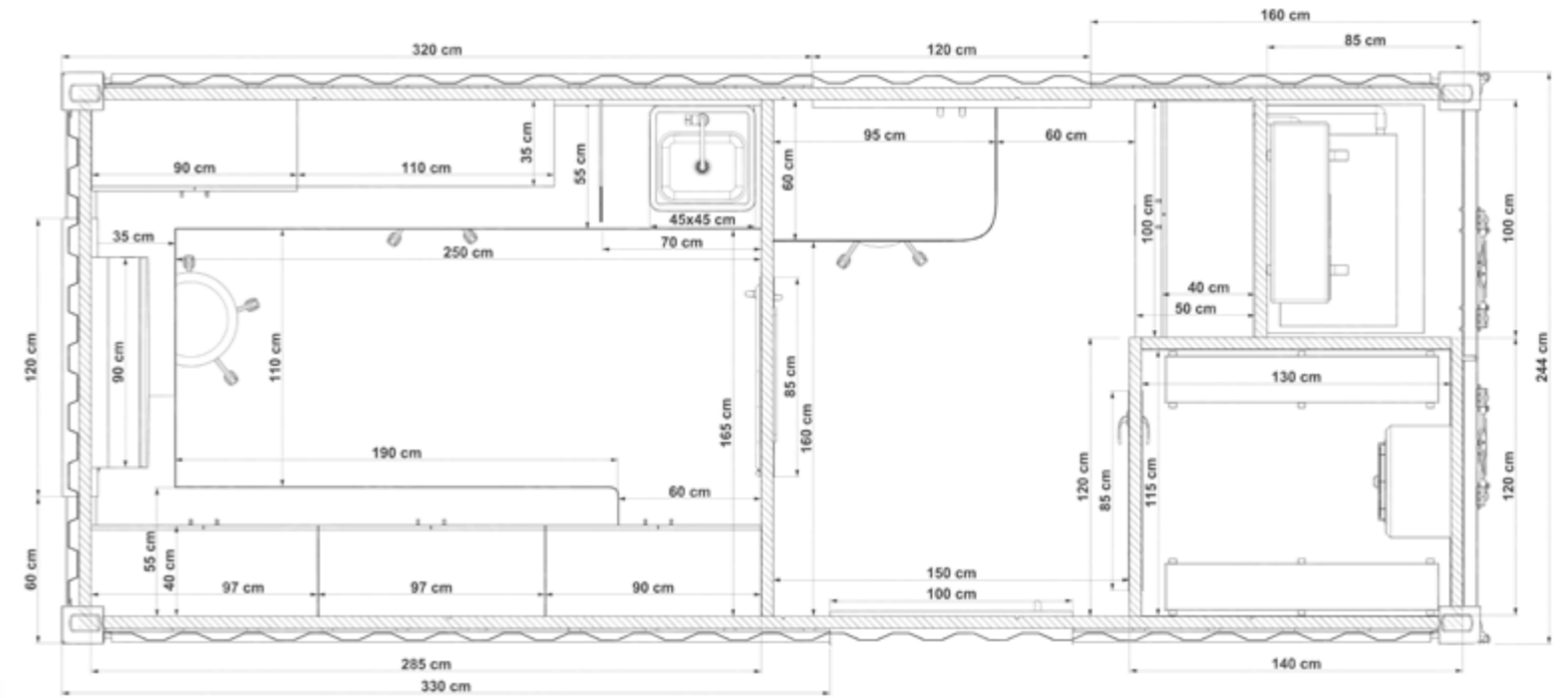

## Front View

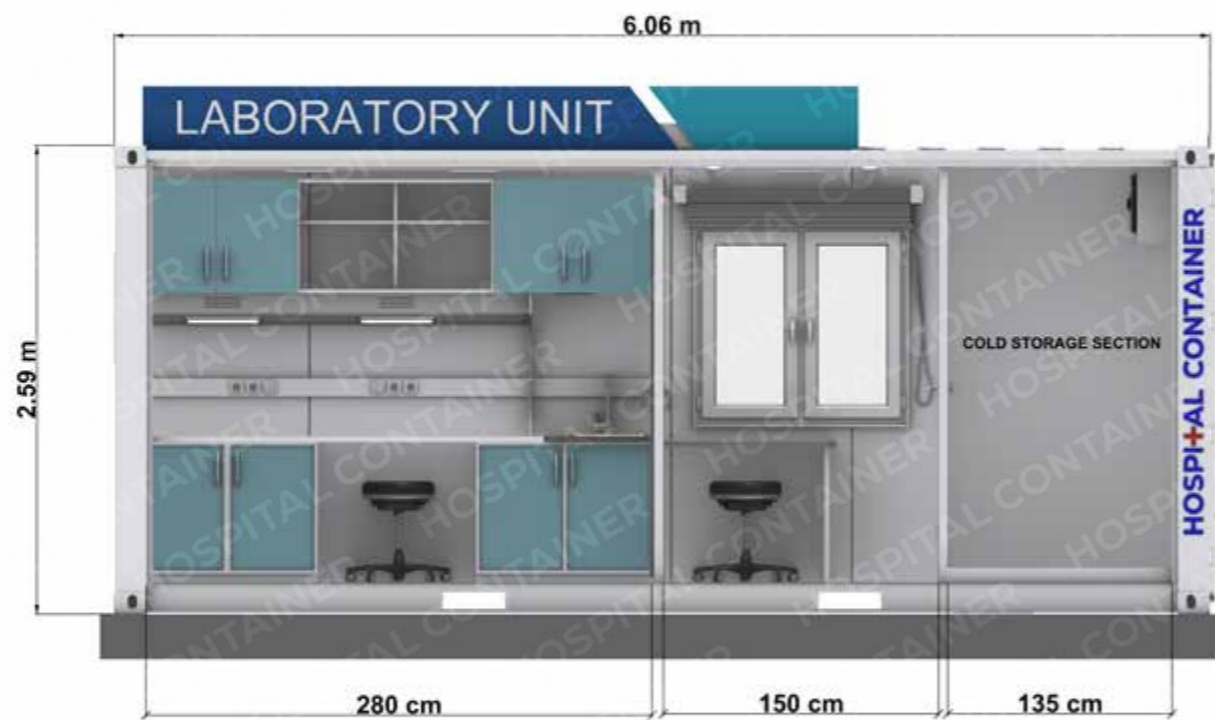

## Top View



## LABORATORY UNIT

# Interior Design

In the laboratory section located to the left in the entrance area, the container laboratory unit contains necessary equipment and materials depending on its intended use. Workbenches on three sides of the room provide a spacious working area for laboratory personnel. Depending on customer needs and requests, laboratory equipment in the container laboratory can vary based on its purpose. There is one sink on the left workbench of the laboratory, and next to the sink, a decorative separator is placed for sterilization purposes. A space is also provided next to the sink for positioning devices or equipment.

On the right workbench, optional LED lighting system can be added to illuminate the working area by installing it underneath the cabinets.

Above the facing workbenches, there are five double-door storage cabinets for laboratory materials needed by the personnel. In the middle section, there is an open shelf for disposable or easily accessible materials.



You can visit the this container by scanning the QR code.

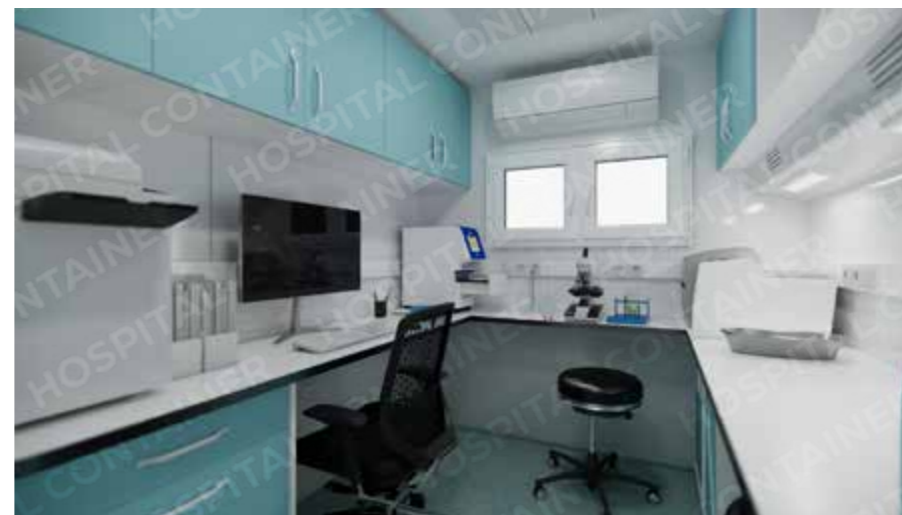

## LABORATORY UNIT

# Interior Design

For the electricity needed in the laboratory section, an optional hybrid power system or solar panel energy system can be installed. There are an adequate number of 220V power outlets within the section.

In the entrance area, there is an operator desk. In the section where the desk is located, there is a double-opening PVC window. Depending on the sector in which the laboratory will be used, this window can be designed as a sliding system or an open window for the delivery of samples to the container. The operator can access the samples through this opening and convey them to the necessary personnel.

In the entrance area, there is a toilet section and a cold storage room. Depending on customer preferences, the toilet includes a clean water source and a wastewater storage unit, toilet cabin, and sink. Clean water is typically supplied from an independent water tank or an external water source. The wastewater system involves the proper processing and storage of used water. Usually, this is facilitated using a waste tank inside the toilet or an external waste tank. This system allows for the safe storage and transport of wastewater without causing harm to the environment.





20FT CONTAINER

# GYNECOLOGY CLINIC



## 20ft Gynecology Clinic

Container Gynecology Clinics are mobile healthcare solutions designed to bring modern medical technology to the most remote areas and facilitate access to women's health. These specialized clinics address women's health needs by offering services such as gynecological examinations, contraceptive counseling, pregnancy monitoring, and gynecological ultrasound.

Each Container Gynecology Clinic is equipped with advanced medical equipment and managed by expert gynecologists. The clinics are furnished with state-of-the-art ultrasound devices, examination tables, sterilization units, and other necessary equipment.

# GYNECOLOGY CLINIC Equipment List

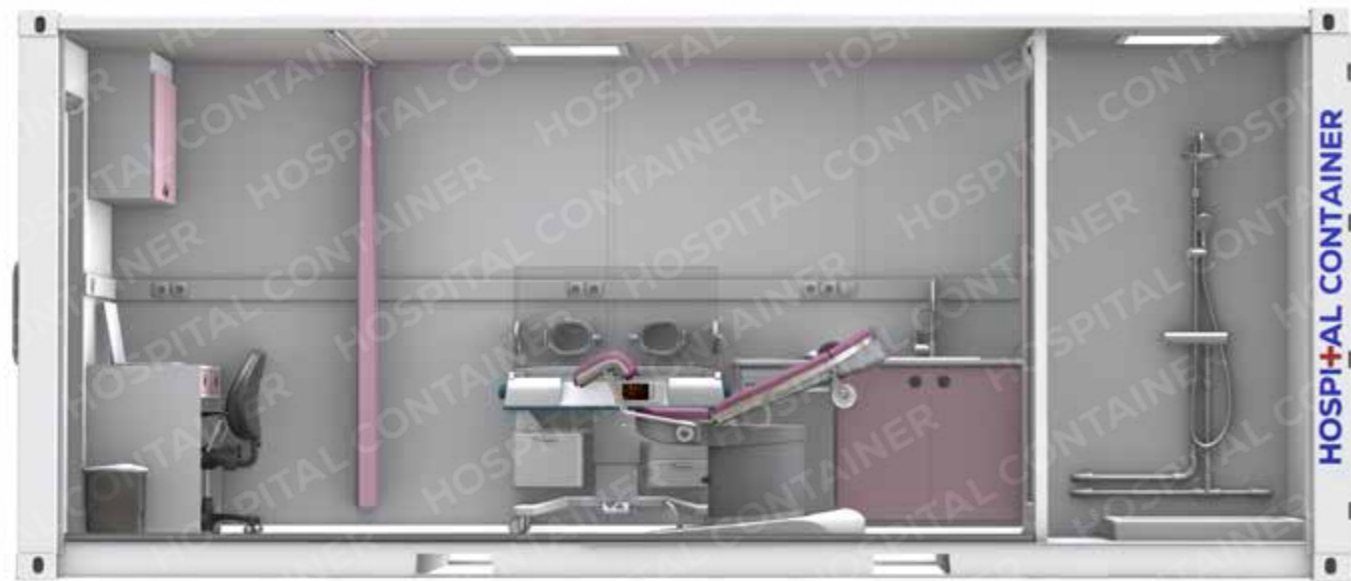

## GYNECOLOGY CLINIC Specifications

### WALLS

**WALL INSULATION** After interior insulation, walls are covered with panels featuring antibacterial properties, either with PVC or aluminum surfaces.

### FLOOR

**FLOOR COATING** 2 mm thick PVC vinyl are used on 14 mm thick board or epoxy coating.

### DOORS

**EXTERNAL / INTERNAL DOOR** The interior and exterior doors of the container can be manufactured from PVC, Aluminum, and Metal materials.

### WINDOWS

**WINDOW** The windows of the container can be manufactured from PVC, Aluminum, and Metal materials. Windows can be single or double-winged and can open up to 90 degrees.

**GLASS** It can be a double glazed window.

### ELECTRIC INSTALLATIONS

**LIGHTING** A moisture-proof luminaire is used.

**PLUGS** Socket - 12V-Inverter (Optional) - Duplex electrical outlet 220V (Optional)

### EQUIPMENTS

Item	Item Code	QTY
Office First Aid Aid Kit	P7775964	1
Diagnostic Kit	P7774093	1
Glove Dispenser	7143865	1
Nitrile Gloves, Size S (Box of 100)	5810227	10
Nitrile Gloves, Size M (Box of 100)	5810228	10
Nitrile Gloves, Size L (Box of 100)	5810229	10
Disinfection/Soap Dispenser (Touchless)	7120766	2
Hand disinfection 1.000ml	5950040	5
Hand soap 1.000ml	7145852	5
Face mask FFP2	5810219	100
Towel Dispenser	5520065	1
Towel (3.200 each)	7052066	1
Garbage can, steel, with foot operated lid	7119528	1
Portable AC/DC suction pump, 230 -240v, Capacity: 18L	7785785	1
Pulse Oximeter	5810091	1
Wall mounted Aneroid Sphygmomanometer, fitted with adult cuff	7785786	1
Blood Glucometer machine with one box of testing stripes	7746136	1
Nebulizer	7785787	1
Minor surgery tool kit (19 pieces)	7785788	1
Ultrasound system	7184182	1
Fetal monitor	7744727	1
Patient Monitor	7185072	1
Infusion pump	7174395	1
Scales	7164033	1
First Aid Kit Maternity Health	P7783234	1
Wheelchair	7767873	1
Examination Lamp suitable for gynecological examinations	7785784	1

### INTERIOR MATERIALS

#### Entrance Area:

Doctor's desk with 2 drawers  
2 x Double-door upper cabinet  
Doctor Chair  
Curtain

#### Gynecology Area:

Double-door base cabinet  
Sink / Faucet  
Upper cabinet  
Shelf with 4 sections  
Gynecology Chair

#### Shower Area:

Shower Tray  
Shower Faucet

# GYNECOLOGY CLINIC Dimensions

## 20ft CONTAINER DIMENSIONS:

**Exterior Dimensions / Area** 6,058 x 2,438 x 2,591 mm / 20' x 8' x 8' 6" / 13.93 m<sup>2</sup>  
L x W x H

**Interior Dimensions / Area** 5,898 x 2,340 x 2,390 mm / 20' x 8' x 8' 6" / 28.33 m<sup>2</sup>  
L x W x H

**Door Dimensions** W x H / 2.34 m x 2.28 m / 7 ft 9 in x 7 ft 6 in

**Volume** 33.2 cubic meters / 1,172 cubic feet

**Weight** It has a tare weight of 5,070 lbs. (2300 kg), a maximum payload weight (max cargo weight) of 55,126.9 lbs. (25,000 kg), and a maximum gross weight of 60,197 lbs. (27,305 kg).

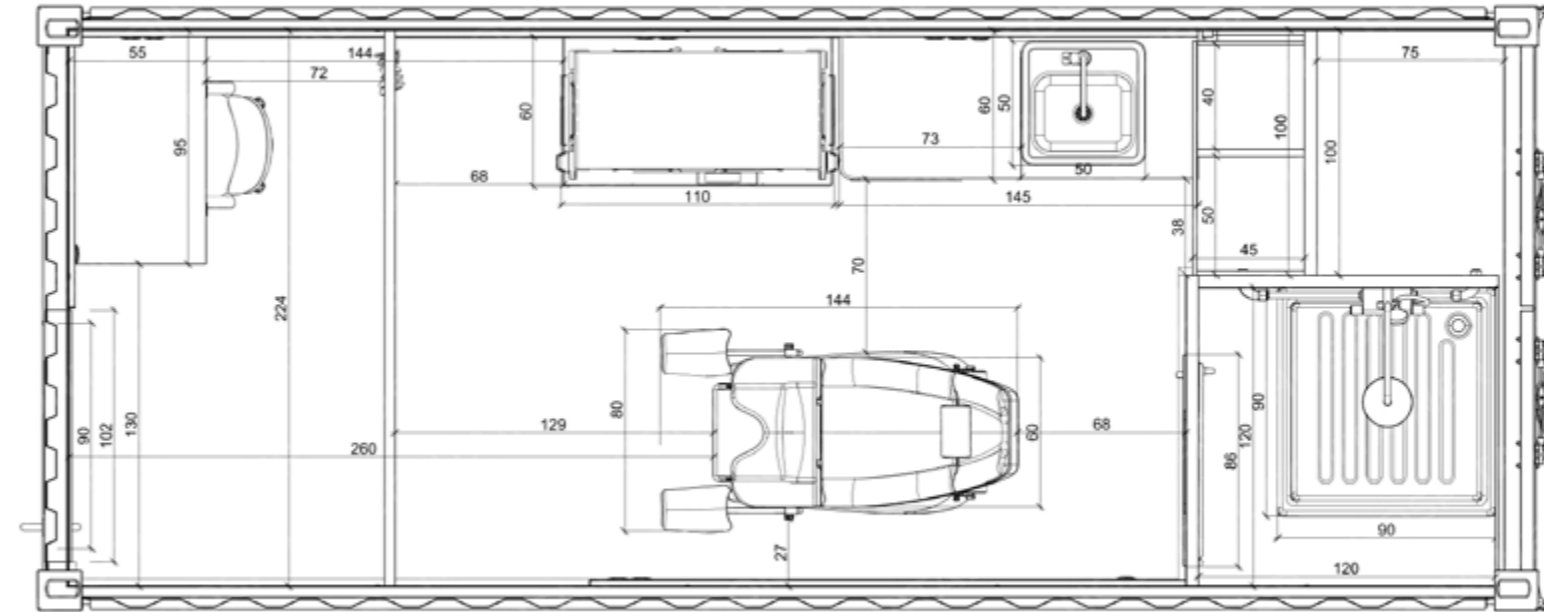

## Front View

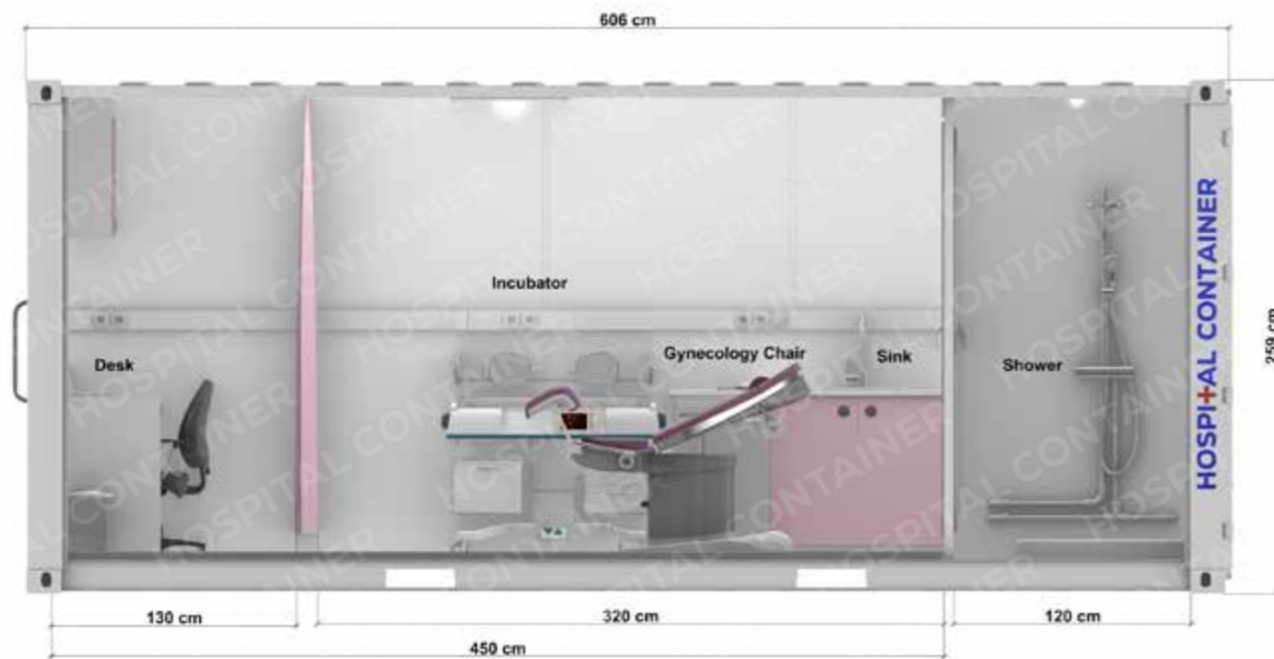

## Top View

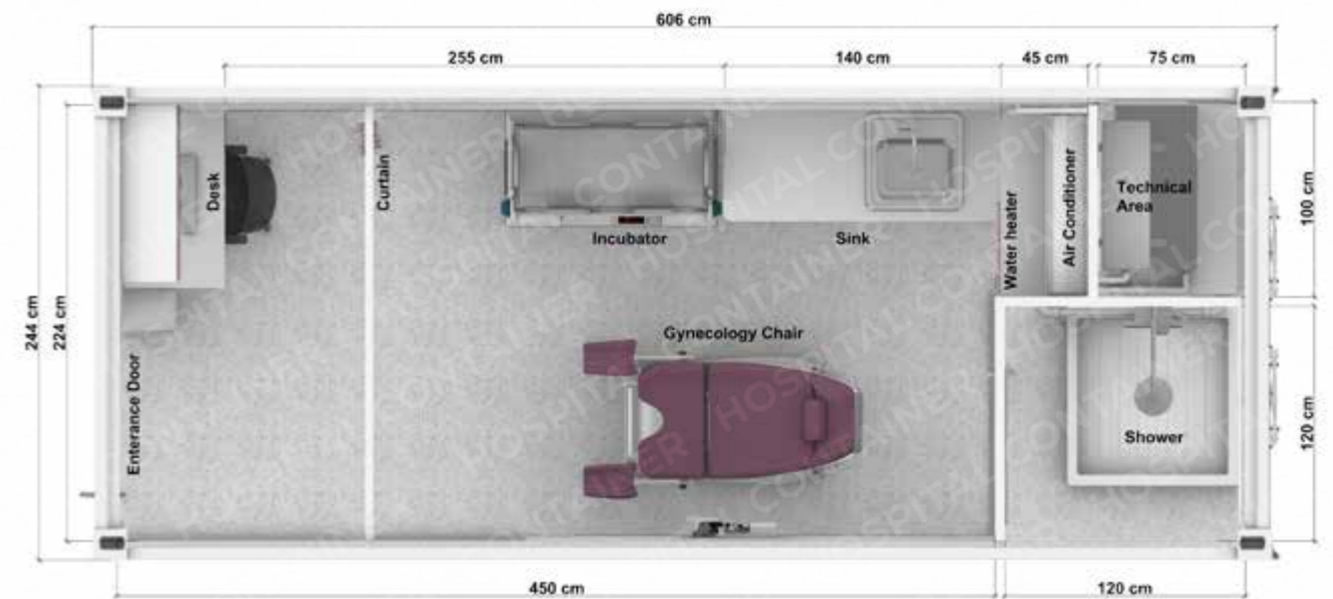

## GYNECOLOGY CLINIC

# Interior Design

The gynecology room is designed to maximize the efficient use of space. In the center, there is a gynecology chair. Workbenches are provided for the staff to quickly access equipment during procedures.

All the necessary equipment for gynecological examinations is available in the room, including an ultrasound device, gynecological tools, a scale, disposable materials, and any additional equipment as per request. The gynecology chair can be positioned differently according to demand and is equipped with an operating light.

Upper and lower cabinets are provided for the storage of materials and equipment. Two workbenches are placed in the room to facilitate the efficient work of the staff, with one workbench having less depth than the other.



You can visit the this container by scanning the QR code.







20FT CONTAINER

# MAMMOGRAPHY CLINIC

[hospitalcontainer.com](http://hospitalcontainer.com)

**HOSPITAL**  
**CONTAINER**



## 20ft Mammography Clinic

Container Mammography Clinics are specially designed mobile healthcare units with the aim of bringing modern medical technology to the most inaccessible areas and facilitating access to breast health. These clinics support women in maintaining healthy lives by providing critical breast health services such as mammography screenings.

Each Container Mammography Clinic is equipped with state-of-the-art mammography devices and expert staff. This enables obtaining high-

quality images necessary for early diagnosis and treatment. The clinics are also designed specifically to ensure that mammography screenings are conducted comfortably and safely.

Container Mammography Clinics offer significant advantages, especially in remote or hard-to-reach areas, during emergency interventions, and in disaster situations. Thanks to their mobile structures, they can be swiftly transported to wherever needed.



## MAMMOGRAPHY CLINIC Equipment List

## MAMMOGRAPHY CLINIC Specifications

### WALLS

**WALL INSULATION** After interior insulation, walls are covered with panels featuring antibacterial properties, either with PVC or aluminum surfaces.

### FLOOR

**FLOOR COATING** 2 mm thick PVC vinyl are used on 14 mm thick board or epoxy coating.

### DOORS

**EXTERNAL / INTERNAL DOOR** The interior and exterior doors of the container can be manufactured from PVC, Aluminum, and Metal materials.

### WINDOWS

**WINDOW** The windows of the container can be manufactured from PVC, Aluminum, and Metal materials. Windows can be single or double-winged and can open up to 90 degrees.

**GLASS** It can be a double glazed window.

### ELECTRIC INSTALLATIONS

**LIGHTING** A moisture-proof luminaire is used.

**PLUGS** Socket - 12V-Inverter (Optional) - Duplex electrical outlet 220V (Optional)

### EQUIPMENTS

#### Item

Office First Aid Aid Kit	Optional
Diagnostic Kit	Optional
Glove Dispenser	Optional
Nitrile Gloves, Size S (Box of 100)	Optional
Nitrile Gloves, Size M (Box of 100)	Optional
Nitrile Gloves, Size L (Box of 100)	Optional
Disinfection/Soap Dispenser (Touchless)	Optional
Hand disinfection 1.000ml	Optional
Hand soap 1.000ml	Optional
Face mask FFP2	Optional
Towel Dispenser	Optional
Towel (3.200 each)	Optional
Garbage can, steel, with foot operated lid	Optional
Digital Mammography Device	Optional
Mammography Films and Plates	Optional
Biopsy Needles and Sets	Optional
Biopsy Guidance Needles	Optional
Biopsy Localization Wires and Clips	Optional
Anesthesia Devices	Optional
Medical Imaging Equipment (X-ray, Ultrasound, etc.)	Optional
Colposcope and Accessories	Optional
Endometrial Biopsy Kit	Optional
Ultrasound Gel	Optional
Hormone Test Kits	Optional

### INTERIOR MATERIALS

#### Entrance Area:

Desk with 2 drawers  
2 x Double-door upper cabinet  
Chair

#### Examination Area:

Double-door base cabinet  
Sink / Faucet  
Upper cabinet  
Patient Bed

#### WC Area:

Toilet  
Sink

# MAMMOGRAPHY CLINIC Dimensions

## 20ft CONTAINER DIMENSIONS:

**Exterior Dimensions / Area** 6,058 x 2,438 x 2,591 mm / 20' x 8' x 8' 6" / 13.93 m<sup>2</sup>  
L x W x H

**Interior Dimensions / Area** 5,898 x 2,340 x 2,390 mm / 20' x 8' x 8' 6" / 28.33 m<sup>2</sup>  
L x W x H

**Door Dimensions** W x H / 2.34 m x 2.28 m / 7 ft 9 in x 7 ft 6 in

**Volume** 33.2 cubic meters / 1,172 cubic feet

**Weight** It has a tare weight of 5,070 lbs. (2300 kg), a maximum payload weight (max cargo weight) of 55,126.9 lbs. (25,000 kg), and a maximum gross weight of 60,197 lbs. (27,305 kg).

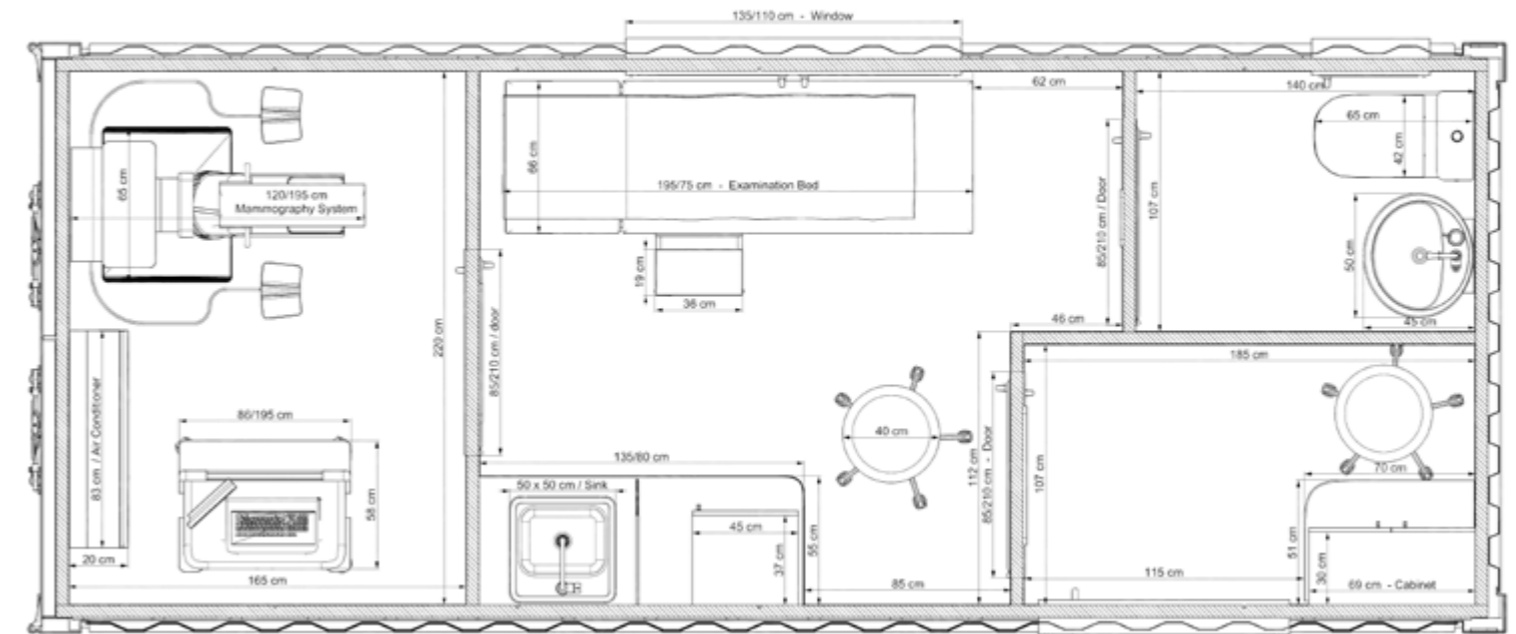

## Front View

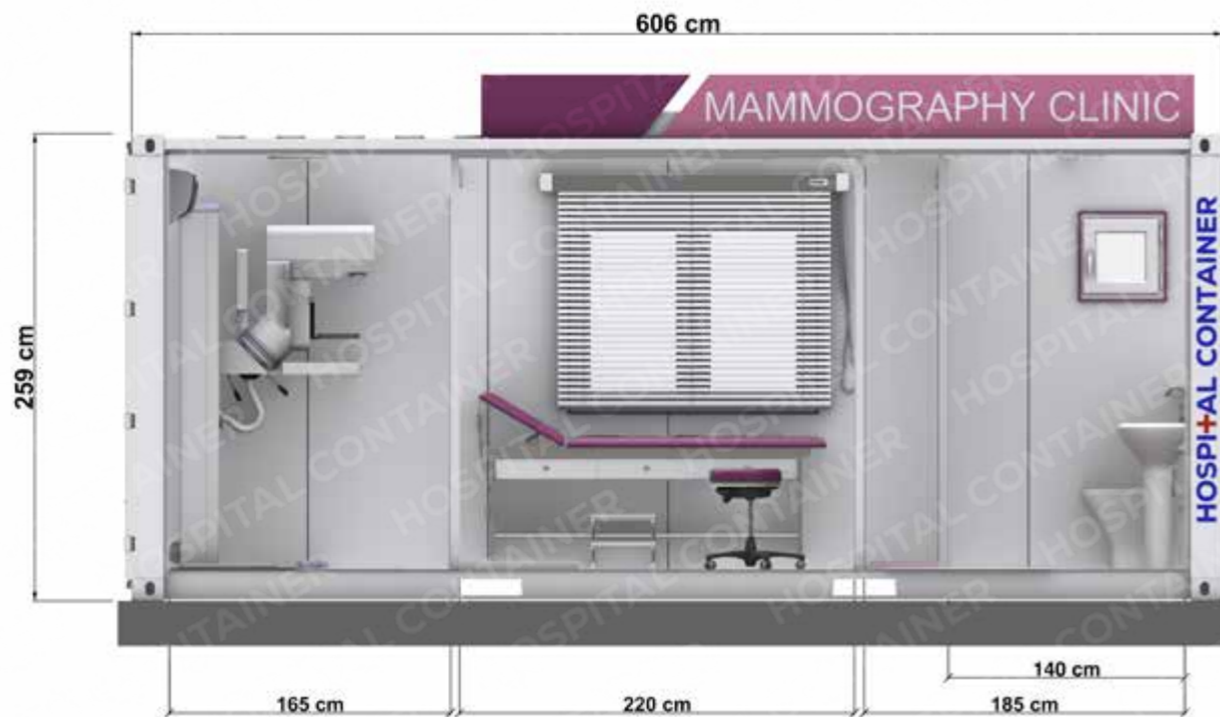

## Top View

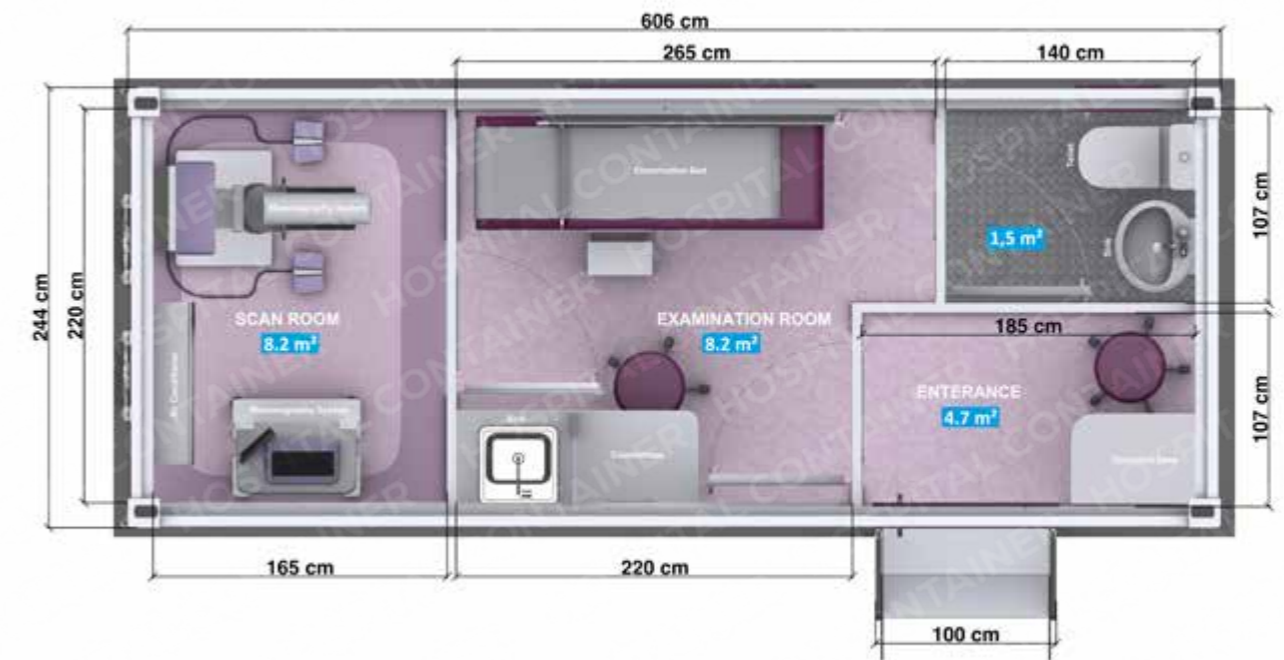

## MAMMOGRAPHY CLINIC Interior Design

The operator section located in the entrance area is where patient records are maintained. Utilizing a narrow space efficiently, a desk and stool have been added. The upper part of the table features a 2-door cabinet designed for the storage of operator materials. Depending on customer requests, a waiting area can also be added to this section. Directives and informational panels can be added to guide visitors to the entrance or examination room.

The examination room is designed for healthcare personnel to use the space most effectively and efficiently. A standard-sized examination bed is present, and for patient comfort, a simple ladder is provided under the bed. Drawers under the examination table allow easy access for healthcare staff to necessary equipment during examinations. Depending on customer preferences, an otoscope-ophthalmoscope-blood pressure monitor set can also be wall-mounted above the examination bed. There are three 220V outlets in the room.



You can visit the this container by scanning the QR code.





20FT CONTAINER

# BLOOD COLLECTION UNIT



## 20ft Blood Collection Unit

Blood collection containers stand out as portable structures that facilitate blood donation processes and make this crucial healthcare service more accessible. These containers are typically used for mobile blood donation events, health camps, emergency responses, and community-based blood donation projects.

Blood collection containers are specially designed to ensure the comfort and safety of donors. Their interiors are arranged to allow donors to easily undergo procedures while enabling healthcare personnel to work effectively.

Additionally, they are equipped with all necessary medical equipment and facilities for proper storage and transportation of blood.

These containers are designed to optimize blood donation processes and promote increased blood donations. Thanks to their mobile and flexible structures, they can be easily transported to various locations for blood donation events. This helps reach a wider audience and contributes to the continuous replenishment of blood stocks.



## BLOOD COLLECTION UNIT Equipment List

The list below includes the basic furnishing products and medical supplies for a container unit. Every unit may have different needs, so this list should be adapted according to specific unit requirements.

## BLOOD COLLECTION UNIT Specifications

### WALLS

**WALL INSULATION** After interior insulation, walls are covered with panels featuring antibacterial properties, either with PVC or aluminum surfaces.

### FLOOR

**FLOOR COATING** 2 mm thick PVC vinyl are used on 14 mm thick board or epoxy coating.

### DOORS

**EXTERNAL / INTERNAL DOOR** The interior and exterior doors of the container can be manufactured from PVC, Aluminum, and Metal materials.

### WINDOWS

**WINDOW** The windows of the container can be manufactured from PVC, Aluminum, and Metal materials. Windows can be single or double-winged and can open up to 90 degrees.

**GLASS** It can be a double glazed window.

### ELECTRIC INSTALLATIONS

**LIGHTING** A moisture-proof luminaire is used.

**PLUGS** Socket - 12V-Inverter (Optional) - Duplex electrical outlet 220V (Optional)

### EQUIPMENTS

#### Item

Office First Aid Aid Kit	Optional
Diagnostic Kit	Optional
Glove Dispenser	Optional
Nitrile Gloves, Size S (Box of 100)	Optional
Nitrile Gloves, Size M (Box of 100)	Optional
Nitrile Gloves, Size L (Box of 100)	Optional
Disinfection/Soap Dispenser (Touchless)	Optional
Hand disinfection 1.000ml	Optional
Hand soap 1.000ml	Optional
Face mask FFP2	Optional
Towel Dispenser	Optional
Towel (3.200 each)	Optional
Garbage can, steel, with foot operated lid	Optional
Blood collection chairs or beds	Optional
Blood pressure monitors	Optional
Pulse oximeters	Optional
Sterile needles and syringes	Optional
Blood collection tubes and containers	Optional
Bandages and adhesive tape	Optional
Alcohol swabs and antiseptic solutions	Optional

### INTERIOR MATERIALS

#### Blood Collection Area:

3 x Blood Collection Chair

3 x Curtain

Trolley

#### Entrance Area:

3 x base cabinet

7 x Upper cabinet

5 drawers

Sink / Faucet

Upper cabinet

Countertop

Staff's desk

Staff's Chair



# BLOOD COLLECTION UNIT

## Dimensions

### 20ft CONTAINER DIMENSIONS:

**Exterior Dimensions / Area** 6,058 x 2,438 x 2,591 mm / 20' x 8' x 8' 6" / 13.93 m<sup>2</sup>  
L x W x H

**Interior Dimensions / Area** 5,898 x 2,340 x 2,390 mm / 20' x 8' x 8' 6" / 28.33 m<sup>2</sup>  
L x W x H

**Door Dimensions** W x H / 2.34 m x 2.28 m / 7 ft 9 in x 7 ft 6 in

**Volume** 33.2 cubic meters / 1,172 cubic feet

**Weight** It has a tare weight of 5,070 lbs. (2300 kg), a maximum payload weight (max cargo weight) of 55,126.9 lbs. (25,000 kg), and a maximum gross weight of 60,197 lbs. (27,305 kg).

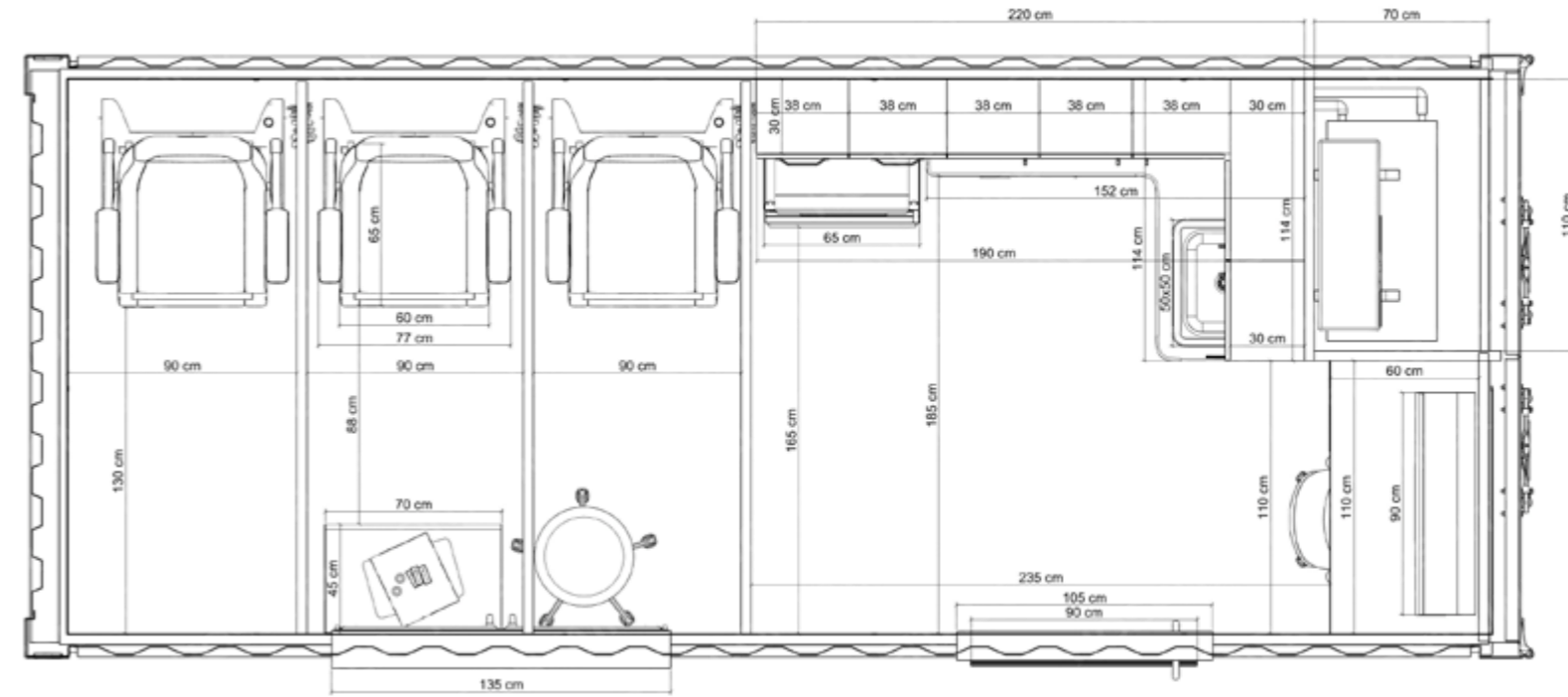

### Front View



### Top View



## BLOOD COLLECTION UNIT Interior Design

This unit, specially designed to meet the rest, clothing change, and personal care needs of healthcare staff, constitutes an important space in healthcare facilities. Inside, there are 3 lockable cabinets where staff can securely store their personal belongings.

Two opposing sofas, intended for relaxation, provide healthcare personnel with a comfortable break area. Additionally, there is a bathroom and toilet area within the unit, equipped with a washing machine for maintaining hygiene. This enables healthcare workers to easily meet their cleanliness and personal care needs.

At the back of the unit, there is a room housing technical equipment. Here, systems are in place to meet the container's water and electricity requirements. Regular maintenance and monitoring of these systems ensure uninterrupted operation, enhancing the functionality of the container and thus improving the efficiency and comfort of healthcare staff.

360°



You can visit the this container  
by scanning the QR code.





40FT CONTAINER

# LOW / HIGH DEPENDENCY UNIT



## 40ft Low/High Dependency Unit

Container low dependency units can be used to provide health services quickly and effectively in mobile health services, emergency medical interventions, or disaster situations.

Container low dependency units can serve as temporary triage centers for emergency medical teams. These centers can be quickly set up in disaster areas and used to classify the injured, determine urgency levels, and plan medical interventions.

Additionally, container low dependency units can be used for public health initiatives such as health screenings, vaccination campaigns, or health education programs. These units offer a portable and flexible solution to bring health services to remote or hard-to-reach areas.

In conclusion, container low dependency units play a vital role in the rapid distribution and effective management of health services and serve as valuable resources in various scenarios such as emergencies or public health initiatives.



## LOW/HIGH DEPENDENCY UNIT Equipment List

The list below includes the basic furnishing products and medical supplies for a container clinic. Every clinic may have different needs, so this list should be adapted according to specific clinic requirements.

## LOW/HIGH DEPENDENCY UNIT Specifications

WALLS	
<b>WALL INSULATION</b>	After interior insulation, walls are covered with panels featuring antibacterial properties, either with PVC or aluminum surfaces.
FLOOR	
<b>FLOOR COATING</b>	2 mm thick PVC vinyl are used on 14 mm thick board or epoxy coating.
DOORS	
<b>EXTERNAL / INTERNAL DOOR</b>	The interior and exterior doors of the container can be manufactured from PVC, Aluminum, and Metal materials.
WINDOWS	
<b>WINDOW</b>	The windows of the container can be manufactured from PVC, Aluminum, and Metal materials. Windows can be single or double-winged and can open up to 90 degrees.
<b>GLASS</b>	It can be a double glazed window.
ELECTRIC INSTALLATIONS	
<b>LIGHTING</b>	A moisture-proof luminaire is used.
<b>PLUGS</b>	Socket - 12V-Inverter (Optional) - Duplex electrical outlet 220V ( Optional)

EQUIPMENTS		
Item	Item Code	QTY
Office First Aid Aid Kit	P7775964	1
Diagnostic Kit	P7774093	1
Glove Dispenser	7143865	1
Nitrile Gloves, Size S (Box of 100)	5810227	10
Nitrile Gloves, Size M (Box of 100)	5810228	10
Nitrile Gloves, Size L (Box of 100)	5810229	10
Disinfection/Soap Dispenser (Touchless)	7120766	2
Hand disinfection 1.000ml	5950040	5
Hand soap 1.000ml	7145852	5
Face mask FFP2	5810219	100
Towel Dispenser	5520065	1
Towel (3.200 each)	7052066	1
Garbage can, steel, with foot operated lid	7119528	1
Low Dependency Hospital Bed	P7774658	4
High Dependency Hospital Bed	P7307732	2
IV Stand	5800282	6
ICU for 1 bed, consisting of ventilation, infusion & monitoring	P7720816	2
Wheelchair	7767873	1
All-terrain stretcher	7786285	1
Crash cart	7742740	2

INTERIOR MATERIALS	
<b>Entrance Area:</b>	<b>Dependency Area:</b>
Double-door, full-length cabinet	Sliding curtain system for each Low Dependency Bed
Countertop	Sliding curtain system for the High Dependency Bed section
Upper Double-Door Cabinet	
Base Double-Door Cabinet	
Sink / Faucet	

# LOW/HIGH DEPENDENCY UNIT

## Dimensions

### 40ft CONTAINER DIMENSIONS:

**Exterior Dimensions / Area** 12,190 × 2,438 × 2,591 mm / 20' × 8' × 8' 6" / 28.13 m<sup>2</sup>  
L × W × H

**Interior Dimensions / Area** 12,025 × 2,340 × 2,390 mm / 20' × 8' × 8' 6" / 28.13 m<sup>2</sup>  
L × W × H



Top View

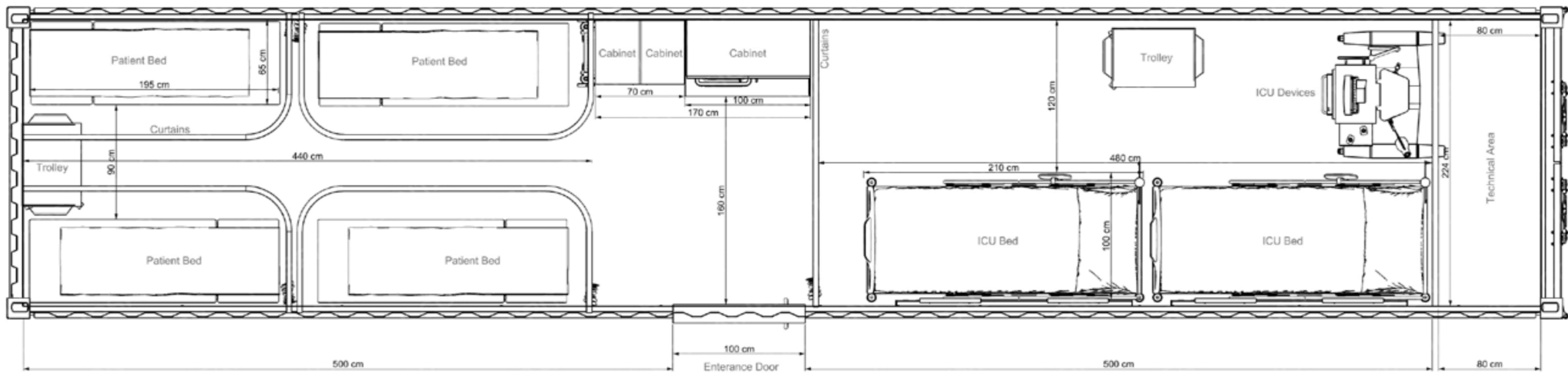

Technical Drawing

## LOW/HIGH DEPENDENCY UNIT Interior Design

Inside the unit, there are a total of 4 Low Dependency Hospital Bed and 2 High Dependency Hospital Bed , each equipped with its own curtain to ensure privacy. Additionally, next to each patient bed, there are trolleys for storing equipment and consumables to be used during the treatment process.

Within this unit, there is one doctor's desk and an accompanying 2-door wardrobe. On the right side of the door, there is a compact cabinet unit. This area includes a sink and provides sufficient countertop space. Cabinets for storing supplies are located in the upper section.

The technical room at the back accommodates systems to meet the container's water and energy requirements. This ensures the functionality of the container and facilitates access to healthcare services for patients.





20FT CONTAINER

# COLD STORAGE UNIT

[hospitalcontainer.com](http://hospitalcontainer.com)

**HOSPITAL**  
CONTAINER





## 20ft Cold Storage Unit

Container cold room units are indispensable for industries requiring precise temperature control, such as pharmaceuticals, food storage, and biotechnology. With their ability to maintain consistent low temperatures, these units safeguard perishable goods and sensitive materials from spoilage and degradation.

Additionally, the customization options for container cold room units are virtually limitless. Every aspect, from the layout of the interior space to the selection of materials and equipment, can be tailored to meet the specific needs and preferences of the customer. They can be configured to

accommodate diverse storage requirements, such as additional shelving, integration of specialized storage racks, or inclusion of humidity control systems.

In addition to their flexibility, container cold room units offer portability and scalability. They can be easily transported and installed at various locations, providing a flexible solution for temporary or remote storage needs. Furthermore, as businesses grow or their storage needs evolve, these units can be expanded or modified, ensuring long-term usability and value.

# COLD STORAGE UNIT Specifications

## WALLS

**WALL INSULATION** After interior insulation, walls are covered with panels featuring antibacterial properties, either with PVC or aluminum surfaces.

## FLOOR

**FLOOR COATING** 2 mm thick PVC vinyl are used on 14 mm thick board or epoxy coating.

## DOORS

**EXTERNAL / INTERNAL DOOR** The interior and exterior doors of the container can be manufactured from PVC, Aluminum, and Metal materials.

## WINDOWS

**WINDOW** The windows of the container can be manufactured from PVC, Aluminum, and Metal materials. Windows can be single or double-winged and can open up to 90 degrees.

**GLASS** It can be a double glazed window.

## ELECTRIC INSTALLATIONS

**LIGHTING** A moisture-proof luminaire is used.

**PLUGS** Socket - 12V-Inverter (Optional) - Duplex electrical outlet 220V ( Optional)



# COLD STORAGE UNIT Equipment List

The list below includes the basic furnishing products and medical supplies for a container clinic. Every clinic may have different needs, so this list should be adapted according to specific clinic requirements.

## EQUIPMENTS

### Item

Cooling unit

Insulation materials

Shelves and storage units

Interior lighting

Air circulation system

Humidity control system

Entrance door and cabinets

Emergency cooling unit

Fire and security alarm

## INTERIOR MATERIALS

### Storage Area:

7 x Shelf

# COLD STORAGE UNIT

## Dimensions

### 20ft CONTAINER DIMENSIONS:

**Exterior Dimensions / Area** 6,058 x 2,438 x 2,591 mm / 20' x 8' x 8' 6" / 13.93 m<sup>2</sup>  
L x W x H

**Interior Dimensions / Area** 5,898 x 2,340 x 2,390 mm / 20' x 8' x 8' 6" / 28.33 m<sup>2</sup>  
L x W x H

**Door Dimensions** W x H / 2.34 m x 2.28 m / 7 ft 9 in x 7 ft 6 in

**Volume** 33.2 cubic meters / 1,172 cubic feet

**Weight** It has a tare weight of 5,070 lbs. (2300 kg), a maximum payload weight (max cargo weight) of 55,126.9 lbs. (25,000 kg), and a maximum gross weight of 60,197 lbs. (27,305 kg).

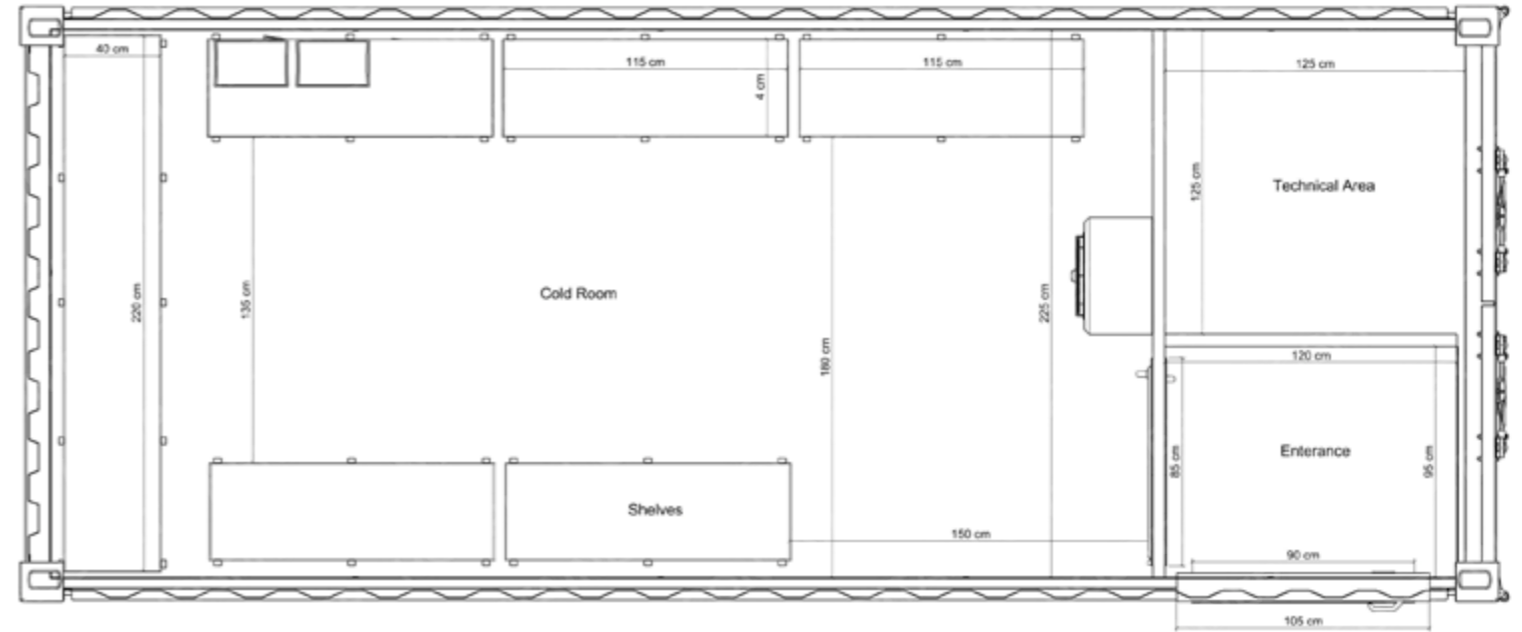

### Front View

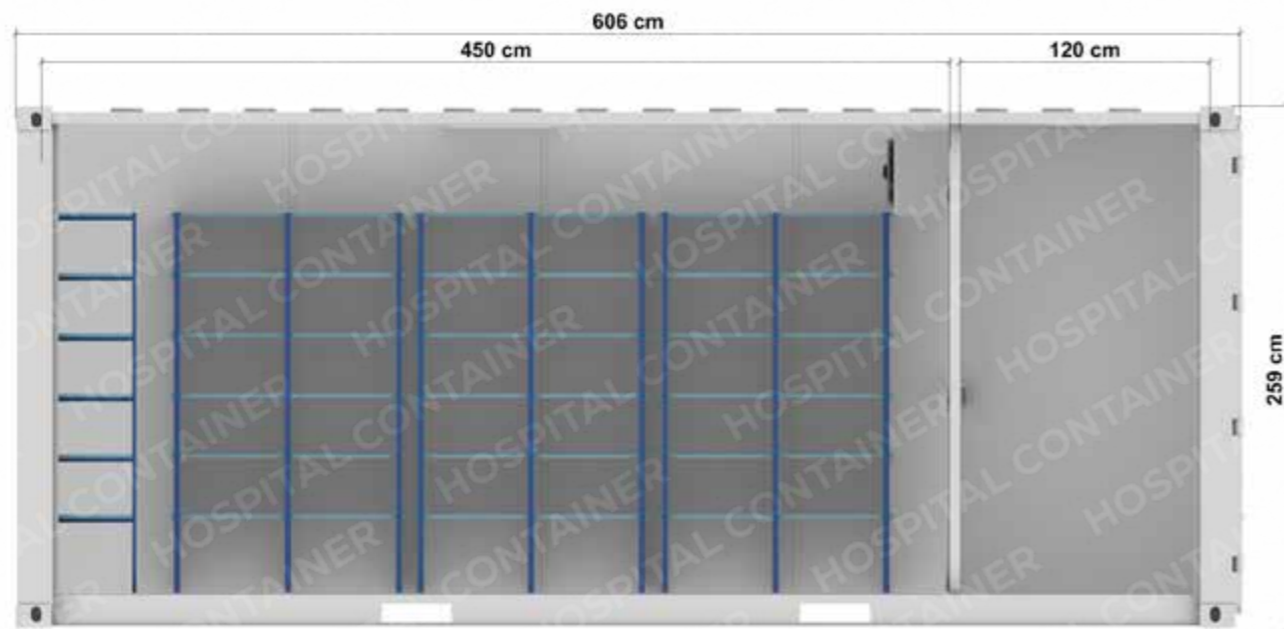

### Top View

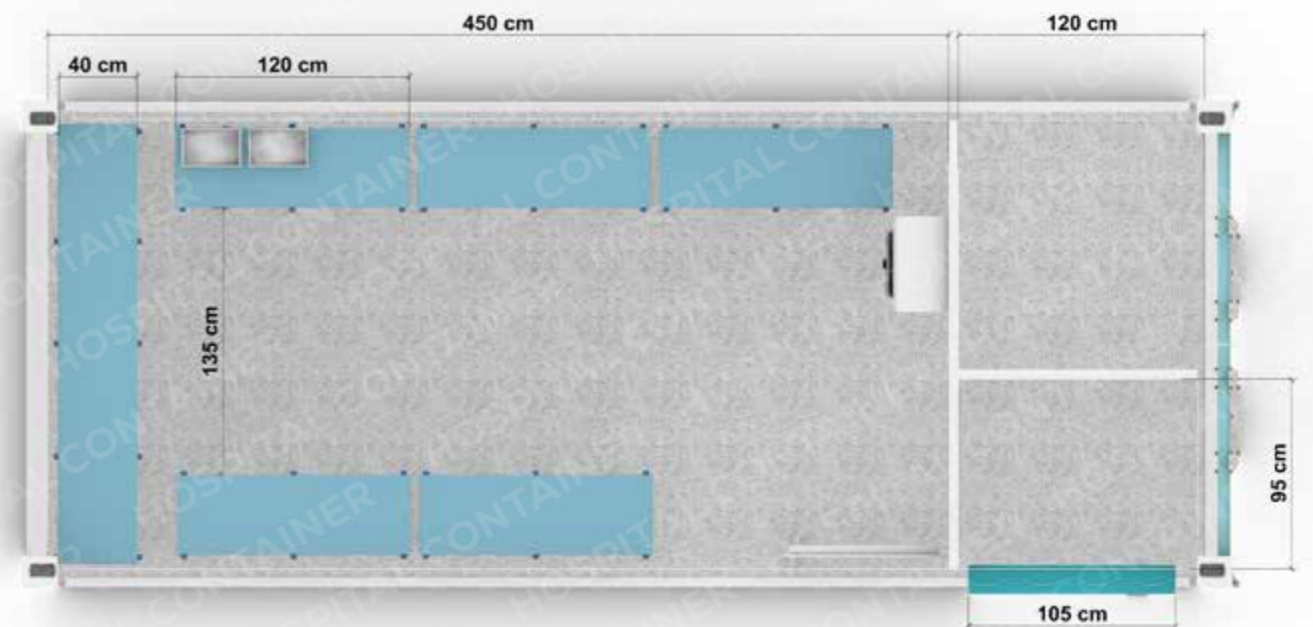

## COLD STORAGE UNIT

# Interior Design

The cold room section is enhanced with advanced technology to optimize storage conditions. State-of-the-art temperature monitoring and control systems continuously regulate the internal environment, ensuring precise temperature management for stored products. Additionally, specialized lighting systems provide adequate illumination while minimizing heat generation, thus preserving the integrity of temperature-sensitive items.

Furthermore, the use of energy-efficient insulation materials and eco-friendly ventilation systems not only maintains desired temperature levels but also reduces energy consumption and environmental impact. This commitment to sustainability reflects our dedication to responsible resource management and is aligned with modern industry standards.



You can visit the this container by scanning the QR code.

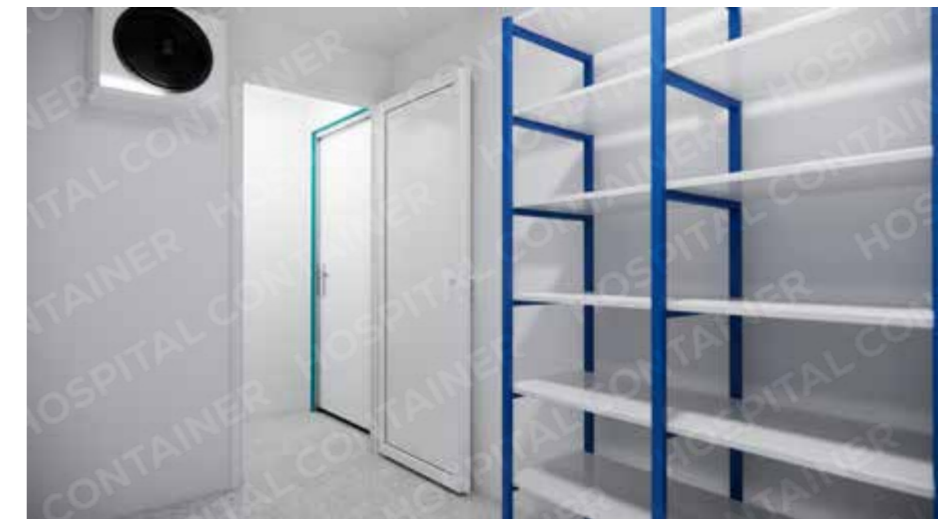



NURSE STATION

HOSPITAL CONTAINER

20FT CONTAINER

# NURSE STATION UNIT



## 20ft Nurse Station

Container nurse stations represent a dedicated space designed to meet the rest and personal needs of nurses in healthcare facilities. These rooms are typically located adjacent to mobile clinics and serve as spaces for nurses to rest and prepare during busy working hours.

These container rooms can be equipped with amenities such as comfortable seating areas, lounging chairs, dining tables, and kitchen equipment according to customer demand. Additionally, lockable cabinets may be available for nurses to store their personal belongings. Basic facilities like

showers and toilets are often included in these rooms to meet hygiene standards.

Nurse rest and changing rooms play a critical role in enhancing the efficiency of healthcare staff. These spaces help reduce nurses' stress, recharge their energy, and better focus on their profession.



## NURSE STATION Specifications

### WALLS

**WALL INSULATION** After interior insulation, walls are covered with panels featuring antibacterial properties, either with PVC or aluminum surfaces.

### FLOOR

**FLOOR COATING** 2 mm thick PVC vinyl are used on 14 mm thick board or epoxy coating.

### DOORS

**EXTERNAL / INTERNAL DOOR** The interior and exterior doors of the container can be manufactured from PVC, Aluminum, and Metal materials.

### WINDOWS

**WINDOW** The windows of the container can be manufactured from PVC, Aluminum, and Metal materials. Windows can be single or double-winged and can open up to 90 degrees.

**GLASS** It can be a double glazed window.

### ELECTRIC INSTALLATIONS

**LIGHTING** A moisture-proof luminaire is used.

**PLUGS** Socket - 12V-Inverter (Optional) - Duplex electrical outlet 220V (Optional)

## NURSE STATION Equipment List

The list below includes the basic furnishing products and medical supplies for a container unit. Every unit may have different needs, so this list should be adapted according to specific unit requirements.

### EQUIPMENTS

Item	Item Code	QTY
Glove Dispenser	7143865	1
Nitrile Gloves, Size S (Box of 100)	5810227	1
Nitrile Gloves, Size M (Box of 100)	5810228	1
Nitrile Gloves, Size L (Box of 100)	5810229	1
Disinfection/Soap Dispenser (Touchless)	7120766	1
Hand disinfection 1.000ml	5950040	1
Hand soap 1.000ml	7145852	1
Face mask FFP2	5810219	1
Towel Dispenser	5520065	1
Towel (3.200 each)	7052066	1
Garbage can, steel, with foot operated lid	7119528	1

### INTERIOR MATERIALS

#### Rest Area:

2 x Sofa  
3 x Lockable cabinet

#### Bath Area:

Shower Tray  
Shower Faucet  
Toilet  
Sink  
Faucet

# NURSE STATION

## Dimensions

### 20ft CONTAINER DIMENSIONS:

**Exterior Dimensions / Area** 6,058 x 2,438 x 2,591 mm / 20' x 8' x 8' 6" / 13.93 m<sup>2</sup>  
L x W x H

**Interior Dimensions / Area** 5,898 x 2,340 x 2,390 mm / 20' x 8' x 8' 6" / 28.33 m<sup>2</sup>  
L x W x H

**Door Dimensions** W x H / 2.34 m x 2.28 m / 7 ft 9 in x 7 ft 6 in

**Volume** 33.2 cubic meters / 1,172 cubic feet

**Weight** It has a tare weight of 5,070 lbs. (2300 kg), a maximum payload weight (max cargo weight) of 55,126.9 lbs. (25,000 kg), and a maximum gross weight of 60,197 lbs. (27,305 kg).

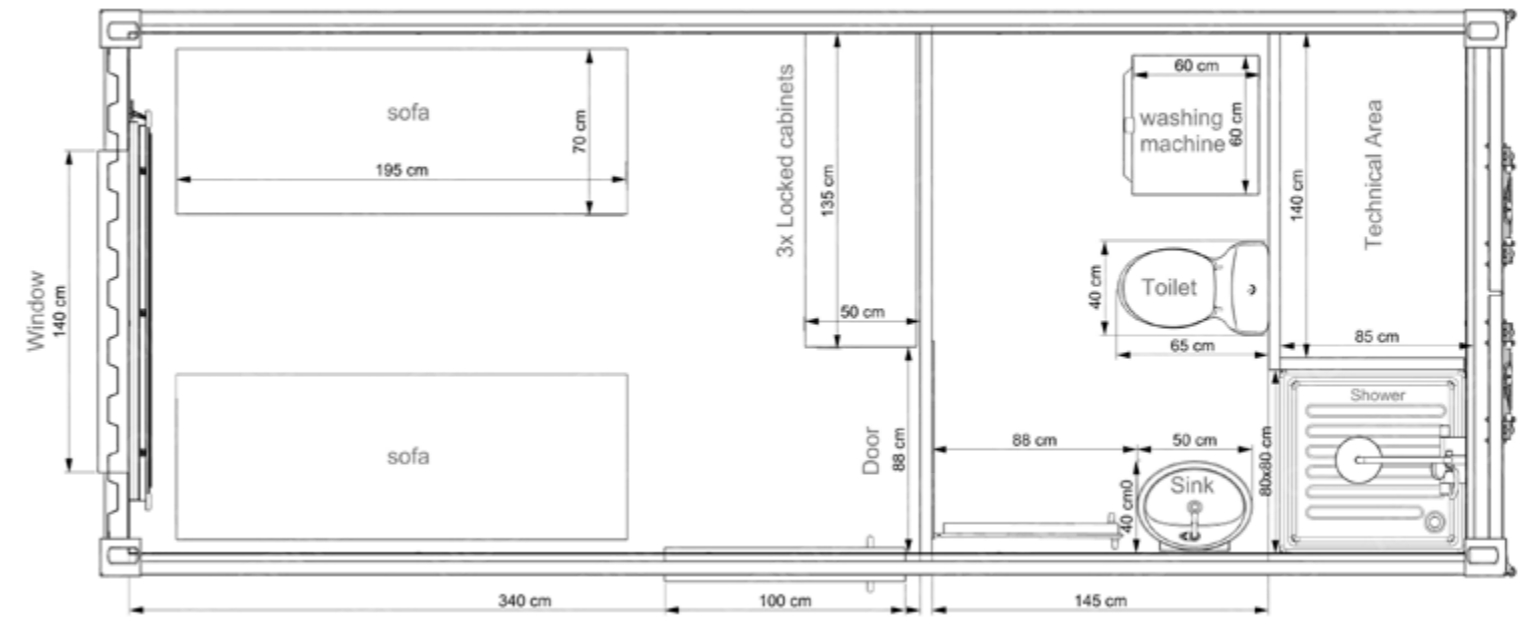

Front View



Top View





NURSE STATION

# Interior Design

This unit, specially designed to meet the rest, clothing change, and personal care needs of healthcare staff, constitutes an important space in healthcare facilities. Inside, there are 3 lockable cabinets where staff can securely store their personal belongings.

Two opposing sofas, intended for relaxation, provide healthcare personnel with a comfortable break area. Additionally, there is a bathroom and toilet area within the unit, equipped with a washing machine for maintaining hygiene. This enables healthcare workers to easily meet their cleanliness and personal care needs.

At the back of the unit, there is a room housing technical equipment. Here, systems are in place to meet the container's water and electricity requirements. Regular maintenance and monitoring of these systems ensure uninterrupted operation, enhancing the functionality of the container and thus improving the efficiency and comfort of healthcare staff.



You can visit the this container by scanning the QR code.





40FT CONTAINER

# STAFF REST ROOM



## 40ft Staff Rest Room

Rest and relaxation areas are crucial for healthcare personnel enduring long shifts. These spaces offer a reprieve from the demands of their work, allowing them to unwind and recharge. Container units designed for rest provide a private retreat for healthcare workers to rejuvenate their energy and morale.

Special containers equipped with showers, toilets, and hygiene supplies address the cleanliness needs of healthcare workers, especially in challenging environments. These facilities ensure staff can maintain personal

hygiene standards, promoting their well-being and the safety of both staff and patients.

By providing these amenities, healthcare organizations demonstrate their commitment to supporting their staff's welfare and creating a conducive work environment. Prioritizing staff needs fosters a culture of care and resilience, ultimately enhancing patient care quality.



## NURSE STATION Specifications

### WALLS

**WALL INSULATION** After interior insulation, walls are covered with panels featuring antibacterial properties, either with PVC or aluminum surfaces.

### FLOOR

**FLOOR COATING** 2 mm thick PVC vinyl are used on 14 mm thick board or epoxy coating.

### DOORS

**EXTERNAL / INTERNAL DOOR** The interior and exterior doors of the container can be manufactured from PVC, Aluminum, and Metal materials.

### WINDOWS

**WINDOW** The windows of the container can be manufactured from PVC, Aluminum, and Metal materials. Windows can be single or double-winged and can open up to 90 degrees.

**GLASS** It can be a double glazed window.

### ELECTRIC INSTALLATIONS

**LIGHTING** A moisture-proof luminaire is used.

**PLUGS** Socket - 12V-Inverter (Optional) - Duplex electrical outlet 220V (Optional)

## STAFF REST ROOM Equipment List

### EQUIPMENTS

Item	Item Code	QTY
Glove Dispenser	7143865	1
Nitrile Gloves, Size S (Box of 100)	5810227	1
Nitrile Gloves, Size M (Box of 100)	5810228	1
Nitrile Gloves, Size L (Box of 100)	5810229	1
Disinfection/Soap Dispenser (Touchless)	7120766	1
Hand disinfection 1.000ml	5950040	1
Hand soap 1.000ml	7145852	1
Face mask FFP2	5810219	1
Towel Dispenser	5520065	1
Towel (3.200 each)	7052066	1
Garbage can, steel, with foot operated lid	7119528	1

### INTERIOR MATERIALS

#### Rest and Bath Area:

Shower Tray

Shower Faucet

Toilet

Sink

Faucet

#### Entrance and Rest Area:

Sofa

4 x Bunk

2 x Lockable cabinet

# STAFF REST ROOM

## Dimensions

### 40ft CONTAINER DIMENSIONS:

**Exterior Dimensions / Area** 12,190 × 2,438 × 2,591 mm / 20' x 8' x 8' 6" / 28.13 m<sup>2</sup>  
L x W x H

**Interior Dimensions / Area** 12,025 × 2,340 × 2,390 mm / 20' x 8' x 8' 6" / 28.13 m<sup>2</sup>  
L x W x H



Top View

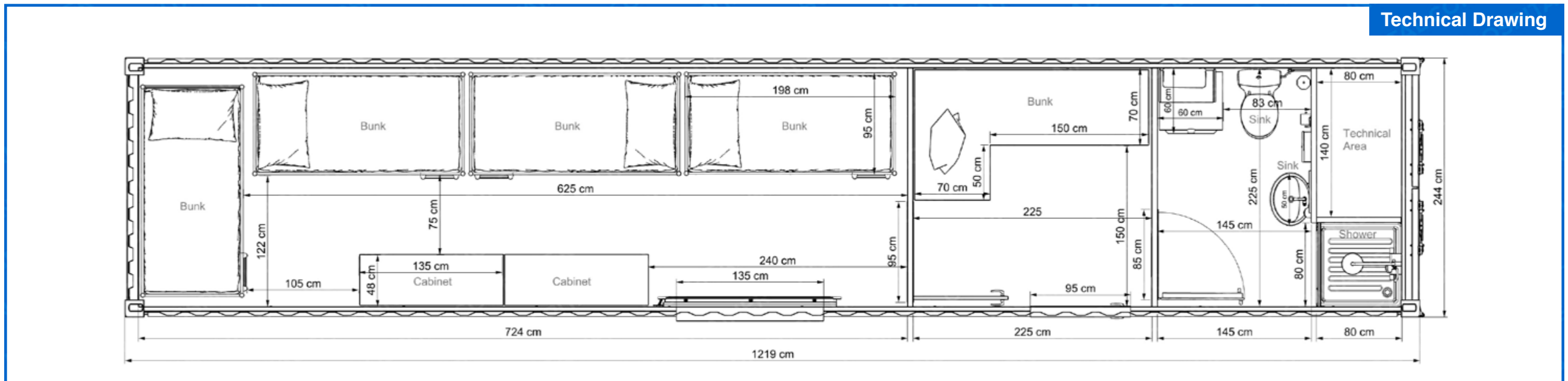

Technical Drawing

STAFF REST ROOM

# Interior Design

In the entrance section of this unit, there is a relaxation area where the staff can unwind and enjoy their time. A corner sofa is placed in this relaxation area for the staff to relax and spend pleasant moments. Upon customer request, a foldable table can be added to this area. On the right side, there is a shower-toilet area equipped with a washing machine, toilet, and sink. The shower section is placed in a separate niche area separated from the technical room, ensuring the most efficient use of space. In the shower area, an 80x80 shower tray with a glass cabin on top has been installed to keep the bathroom area dry while showering.

In the left part of the entrance, there are four bunk beds added to the relaxation and sleeping area. Alongside the bunk beds, six-section wardrobes are placed, allowing for storage space. A double-opening window is added for room ventilation. Depending on customer requests and needs, air conditioning can be added to this room to ensure temperature balance within the environment.



You can visit the this container by scanning the QR code.





40FT CONTAINER

# KITCHEN UNIT

[hospitalcontainer.com](http://hospitalcontainer.com)

**HOSPITAL**  
**CONTAINER**

## KITCHEN



## 40ft Kitchen Unit

Container kitchen units are an ideal solution for meal preparation and serving in field hospitals. These units are designed to maximize efficiency in limited space. Kitchen equipment includes portable stoves, ovens, microwaves, refrigerators, and freezers.

These container kitchen units allow healthcare staff and other workers to prepare adequate and nutritious meals. Additionally, they are made of easily cleanable and disinfectable materials to maintain high hygiene standards.

Used in field hospitals, 40 ft container kitchen units contribute to the successful operation by ensuring the staff's access to healthy and nutritious meals. Such facilities are crucial in supporting the delivery of effective healthcare services in field conditions.





## KITCHEN UNIT Specifications

### WALLS

**WALL INSULATION** After interior insulation, walls are covered with panels featuring antibacterial properties, either with PVC or aluminum surfaces.

### FLOOR

**FLOOR COATING** 2 mm thick PVC vinyl are used on 14 mm thick board or epoxy coating.

### DOORS

**EXTERNAL / INTERNAL DOOR** The interior and exterior doors of the container can be manufactured from PVC, Aluminum, and Metal materials.

### WINDOWS

**WINDOW** The windows of the container can be manufactured from PVC, Aluminum, and Metal materials. Windows can be single or double-winged and can open up to 90 degrees.

**GLASS** It can be a double glazed window.

### ELECTRIC INSTALLATIONS

**LIGHTING** A moisture-proof luminaire is used.

**PLUGS** Socket - 12V-Inverter (Optional) - Duplex electrical outlet 220V (Optional)

## KITCHEN UNIT Equipment List

The list below includes the basic furnishing products and medical supplies for a container clinic. Every clinic may have different needs, so this list should be adapted according to specific clinic requirements.

### EQUIPMENTS

Portable stoves	Optional
Ovens	Optional
Microwaves	Optional
Refrigerators	Optional
Freezers	Optional
Cooking utensils (pots, pans, spatulas, etc.)	Optional
Food preparation surfaces (cutting boards, countertops)	Optional
Sinks for washing dishes and food items	Optional
Dishwashing equipment (dish racks, dish soap, scrub brushes)	Optional
Storage containers for dry goods and ingredients	Optional
Shelving units for organizing kitchen supplies	Optional
Dining tables and chairs for meal consumption	Optional
Serving utensils (plates, bowls, utensils, etc.)	Optional
Cleaning supplies (mops, brooms, disinfectants)	Optional
Waste disposal bins	Optional

# KITCHEN UNIT

## Dimensions

### 40ft CONTAINER DIMENSIONS:

**Exterior Dimensions / Area** 12.190 x 2,438 x 2,591 mm / 20' x 8' x 8' 6" / 28.13 m<sup>2</sup>  
L x W x H

**Interior Dimensions / Area** 12,025 x 2,340 x 2,390 mm / 20' x 8' x 8' 6" / 28.13 m<sup>2</sup>  
L x W x H



Top View

Technical Drawing

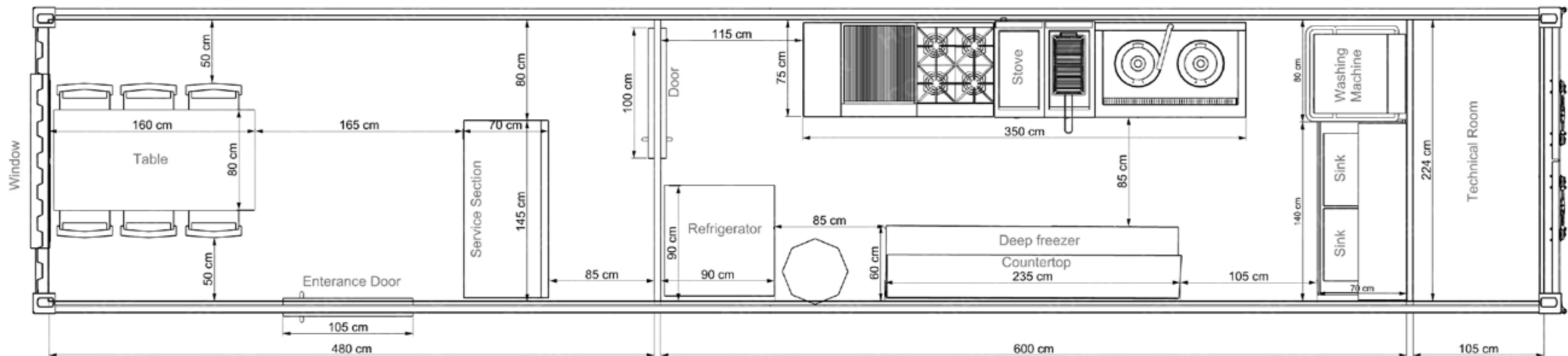

## KITCHEN UNIT Interior Design

At the entrance of the kitchen unit, there is a six-chair table where the staff can have their meals. There is a buffet or a self-service area arranged for them to obtain their meals. This setup provides an environment where the staff can comfortably take their meals and sit.

At the back, there is a spacious cooking area equipped with stoves, refrigerators, freezers, and other necessary cooking equipment. With stainless steel countertops, an industrial standard kitchen environment is created in this area. This ensures that meals are prepared and served in a hygienic manner.

A large technical room at the back of the container houses the water and electrical systems needed for the unit. This room ensures the provision of energy and water required by the container. The secure and orderly operation of these systems ensures the smooth functioning of the kitchen unit and meets the staff's meal needs.



You can visit the this container  
by scanning the QR code.

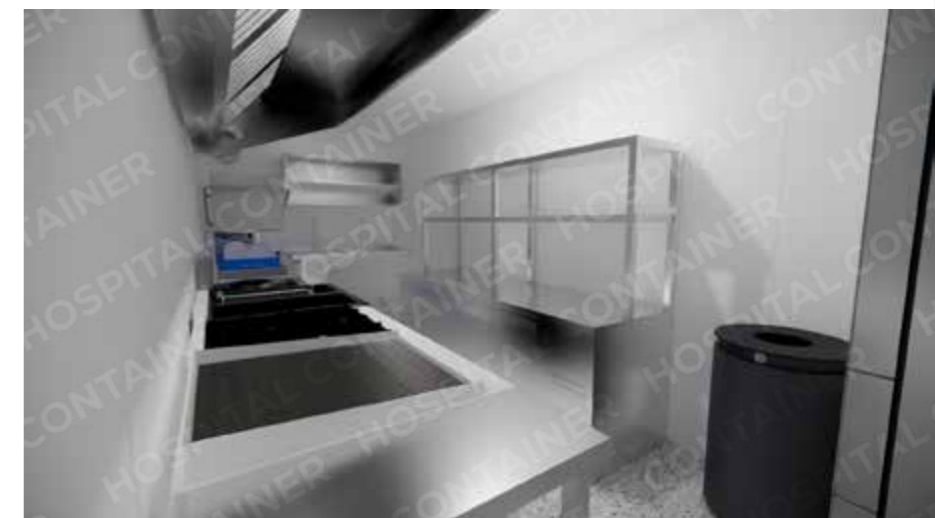



40FT CONTAINER

# MORGUE UNIT

[hospitalcontainer.com](http://hospitalcontainer.com)

**HOSPITAL**  
**CONTAINER**



## 40ft Morgue Unit

Container morgue units are portable morgue facilities used during emergencies or disasters. These units are typically equipped with specialized equipment installed inside large containers. They provide a suitable environment for the preservation, identification, and necessary procedures of deceased bodies.

These types of morgue units can be quickly set up and made operational during emergencies such as natural disasters, accidents, outbreaks of diseases, or other emergencies. The portability of the containers provides

flexibility to local health authorities or rescue teams and can be rapidly relocated when needed.

Container morgue units offer health workers and law enforcement agencies the ability to manage the process of handling and identifying deceased bodies more effectively. Additionally, these units can be used to meet excess demand when the capacity of regular morgue facilities is exceeded and help alleviate the burden on healthcare systems during emergencies.



## MORGUE UNIT Specifications

### WALLS

**WALL INSULATION** After interior insulation, walls are covered with panels featuring antibacterial properties, either with PVC or aluminum surfaces.

### FLOOR

**FLOOR COATING** 2 mm thick PVC vinyl are used on 14 mm thick board or epoxy coating.

### DOORS

**EXTERNAL / INTERNAL DOOR** The interior and exterior doors of the container can be manufactured from PVC, Aluminum, and Metal materials.

### WINDOWS

**WINDOW** The windows of the container can be manufactured from PVC, Aluminum, and Metal materials. Windows can be single or double-winged and can open up to 90 degrees.

**GLASS** It can be a double glazed window.

### ELECTRIC INSTALLATIONS

**LIGHTING** A moisture-proof luminaire is used.

**PLUGS** Socket - 12V-Inverter (Optional) - Duplex electrical outlet 220V (Optional)

## MORGUE UNIT Equipment List

### EQUIPMENTS

#### Item

Glove Dispenser	Optional
Nitrile Gloves, Size S (Box of 100)	Optional
Nitrile Gloves, Size M (Box of 100)	Optional
Nitrile Gloves, Size L (Box of 100)	Optional
Disinfection/Soap Dispenser (Touchless)	Optional
Hand disinfection 1.000ml	Optional
Hand soap 1.000ml	Optional
Face mask FFP2	Optional
Towel Dispenser	Optional
Towel (3.200 each)	Optional
Garbage can, steel, with foot operated lid	Optional

### INTERIOR MATERIALS

#### Washing Area:

Washing desk  
 Double-door base cabinet  
 Double-door upper cabinet  
 Countertop  
 Sink / Faucet

#### Morgue Area:

2 x Morgue refrigerator (3Body)

# MORGUE UNIT

## Dimensions

### 40ft CONTAINER DIMENSIONS:

**Exterior Dimensions / Area** 12.190 x 2,438 x 2,591 mm / 20' x 8' x 8' 6" / 28.13 m<sup>2</sup>  
L x W x H

**Interior Dimensions / Area** 12,025 x 2,340 x 2,390 mm / 20' x 8' x 8' 6" / 28.13 m<sup>2</sup>  
L x W x H



Top View

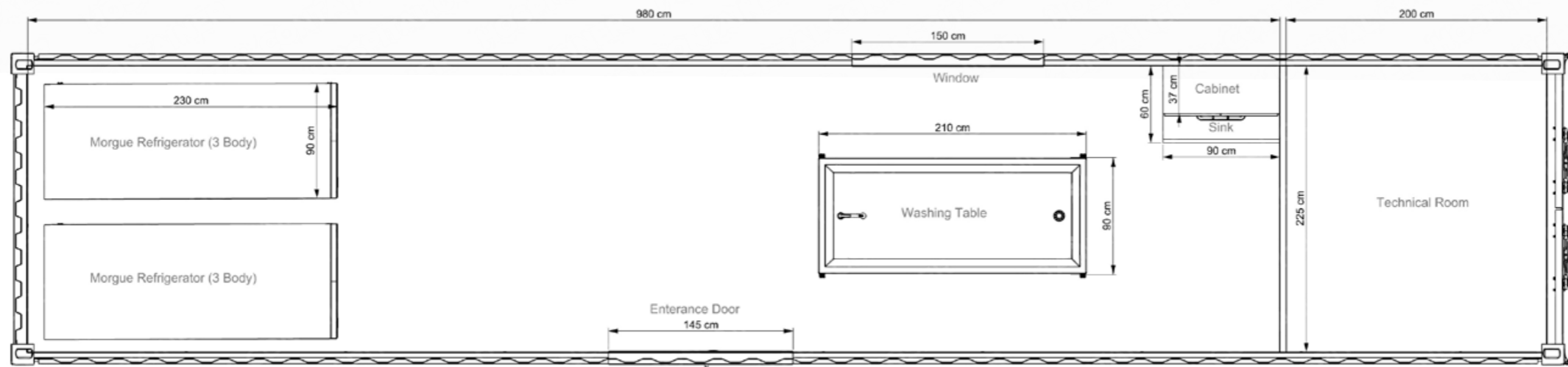

Technical Drawing

## MORGUE UNIT

# Interior Design

The right side of this unit is designated as the area where dead bodies will be washed. This section contains a washing table. The cabinet section where the staff will store the equipment is located in this area. Designed with two lower cabinets and two upper cabinets, the interior space is efficiently utilized to meet storage needs.

On the left side of the entrance area, 2 refrigerated morgue units have been placed. Each of these units has a capacity of 3 bodies, allowing a total of 6 bodies to be stored. The water and energy needs of the unit are provided through the systems installed in the technical room located at the back of this unit.



360°



You can visit the this container by scanning the QR code.





20FT CONTAINER

# WC & SHOWER UNIT



## 20ft Wc&Shower Unit

Wc&shower container offer an ideal solution to meet hygiene needs by providing a portable and modular option. These facilities have a wide range of applications in various areas, particularly in emergency situations such as temporary events, construction sites, campgrounds, disaster areas, and Saharan hospitals.

Wc&shower container stand out with their quick and easy installation. Integrated systems ensure smooth water and waste management. Regular cleaning and disinfection maintain hygiene standards, and they are ergonomically designed with user comfort and health in mind.

With their broad range of applications, these facilities provide a solution suitable for both temporary and long-term needs. Their portability makes them highly flexible, allowing them to be used in various environments. With their reliability and ease of use, they offer an indispensable solution for maintaining hygiene and meeting cleanliness needs.

# WC&SHOWER UNIT Specifications

## WALLS

**WALL INSULATION** After interior insulation, walls are covered with panels featuring antibacterial properties, either with PVC or aluminum surfaces.

## FLOOR

**FLOOR COATING** 2 mm thick PVC vinyl are used on 14 mm thick board or epoxy coating.

## DOORS

**EXTERNAL / INTERNAL DOOR** The interior and exterior doors of the container can be manufactured from PVC, Aluminum, and Metal materials.

## WINDOWS

**WINDOW** The windows of the container can be manufactured from PVC, Aluminum, and Metal materials. Windows can be single or double-winged and can open up to 90 degrees.

**GLASS** It can be a double glazed window.

## ELECTRIC INSTALLATIONS

**LIGHTING** A moisture-proof luminaire is used.

**PLUGS** Socket - 12V-Inverter (Optional) - Duplex electrical outlet 220V ( Optional)



# WC&SHOWER UNIT Equipment List

The list below includes the basic furnishing products and medical supplies for a container clinic. Every clinic may have different needs, so this list should be adapted according to specific clinic requirements.

## EQUIPMENTS

### Item

Disinfection/Soap Dispenser (Touchless)	Optional
Hand disinfection 1.000ml	Optional
Hand soap 1.000ml	Optional
Towel Dispenser	Optional
Towel (3.200 each)	Optional
Garbage can, steel, with foot operated lid	Optional
Ceramic toilet and sink	Optional
Ceramic shower tray	Optional
Toilet paper dispensers	Optional
Hand dryers	Optional
Towel dispensers	Optional
Ventilation systems	Optional
Soap dispensers	Optional
Hand sanitizer dispensers	Optional
Shower heads and faucets	Optional
Towel racks	

# WC&SHOWER UNIT Dimensions

## 20ft CONTAINER DIMENSIONS:

**Exterior Dimensions / Area** 6,058 x 2,438 x 2,591 mm / 20' x 8' x 8' 6" / 13.93 m<sup>2</sup>  
L x W x H

**Interior Dimensions / Area** 5,898 x 2,340 x 2,390 mm / 20' x 8' x 8' 6" / 28.33 m<sup>2</sup>  
L x W x H

**Door Dimensions** W x H / 2.34 m x 2.28 m / 7 ft 9 in x 7 ft 6 in

**Volume** 33.2 cubic meters / 1,172 cubic feet

**Weight** It has a tare weight of 5,070 lbs. (2300 kg), a maximum payload weight (max cargo weight) of 55,126.9 lbs. (25,000 kg), and a maximum gross weight of 60,197 lbs. (27,305 kg).

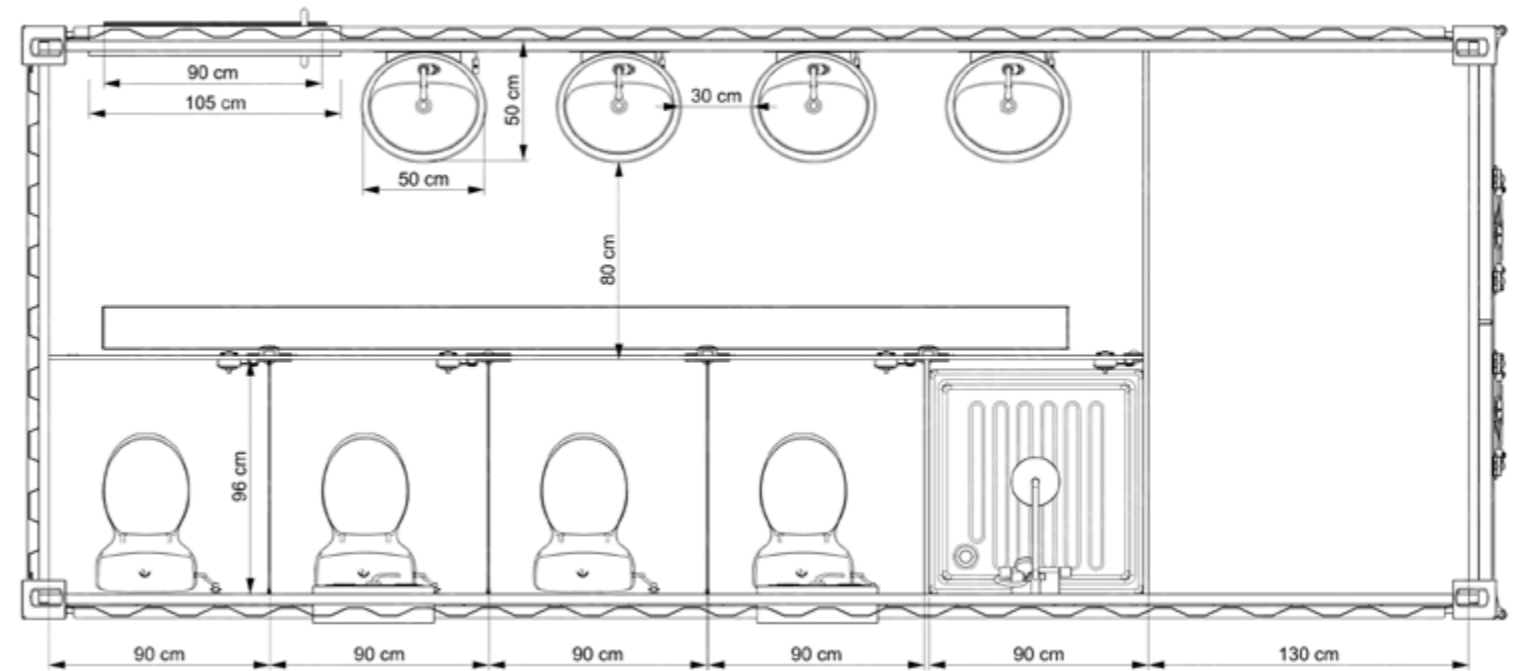

Front View



Top View



## WC&SHOWER UNIT

# Interior Design

This unit is equipped with four sinks to meet the needs of users. These sinks are located in a communal area and are carefully designed to provide a hygienic environment. Opposite the sinks are cabins designed to offer a comfortable experience. Three of these cabins serve as toilets while one functions as a shower cabin. Each cabin is equipped with ceramic toilets and a shower tray to meet users' basic hygiene needs.

The unit's water and electricity needs are met by specially designed systems to ensure uninterrupted service. These systems are located in the technical room at the rear of the container. As a result, users' needs are quickly and reliably met without any disruptions in water and electricity supply. This container unit offers a practical and effective solution, providing an ideal option to meet hygiene standards and ensure user comfort.



You can visit the this container by scanning the QR code.





20FT CONTAINER

# TECHNICAL UNIT

# TECHNICAL UNIT

## Dimensions

### 20ft CONTAINER DIMENSIONS:

**Exterior Dimensions / Area** 6,058 x 2,438 x 2,591 mm / 20' x 8' x 8' 6" / 13.93 m<sup>2</sup>  
L x W x H

**Interior Dimensions / Area** 5,898 x 2,340 x 2,390 mm / 20' x 8' x 8' 6" / 28.33 m<sup>2</sup>  
L x W x H

**Door Dimensions** W x H / 2.34 m x 2.28 m / 7 ft 9 in x 7 ft 6 in

**Volume** 33.2 cubic meters / 1,172 cubic feet

**Weight** It has a tare weight of 5,070 lbs. (2300 kg), a maximum payload weight (max cargo weight) of 55,126.9 lbs. (25,000 kg), and a maximum gross weight of 60,197 lbs. (27,305 kg).





20FT CONTAINER

# OXYGEN UNIT



# OXYGEN UNIT

## Dimensions

### 20ft CONTAINER DIMENSIONS:

**Exterior Dimensions / Area** 6,058 x 2,438 x 2,591 mm / 20' x 8' x 8' 6" / 13.93 m<sup>2</sup>  
L x W x H

**Interior Dimensions / Area** 5,898 x 2,340 x 2,390 mm / 20' x 8' x 8' 6" / 28.33 m<sup>2</sup>  
L x W x H

**Door Dimensions** W x H / 2.34 m x 2.28 m / 7 ft 9 in x 7 ft 6 in

**Volume** 33.2 cubic meters / 1,172 cubic feet

**Weight** It has a tare weight of 5,070 lbs. (2300 kg), a maximum payload weight (max cargo weight) of 55,126.9 lbs. (25,000 kg), and a maximum gross weight of 60,197 lbs. (27,305 kg).

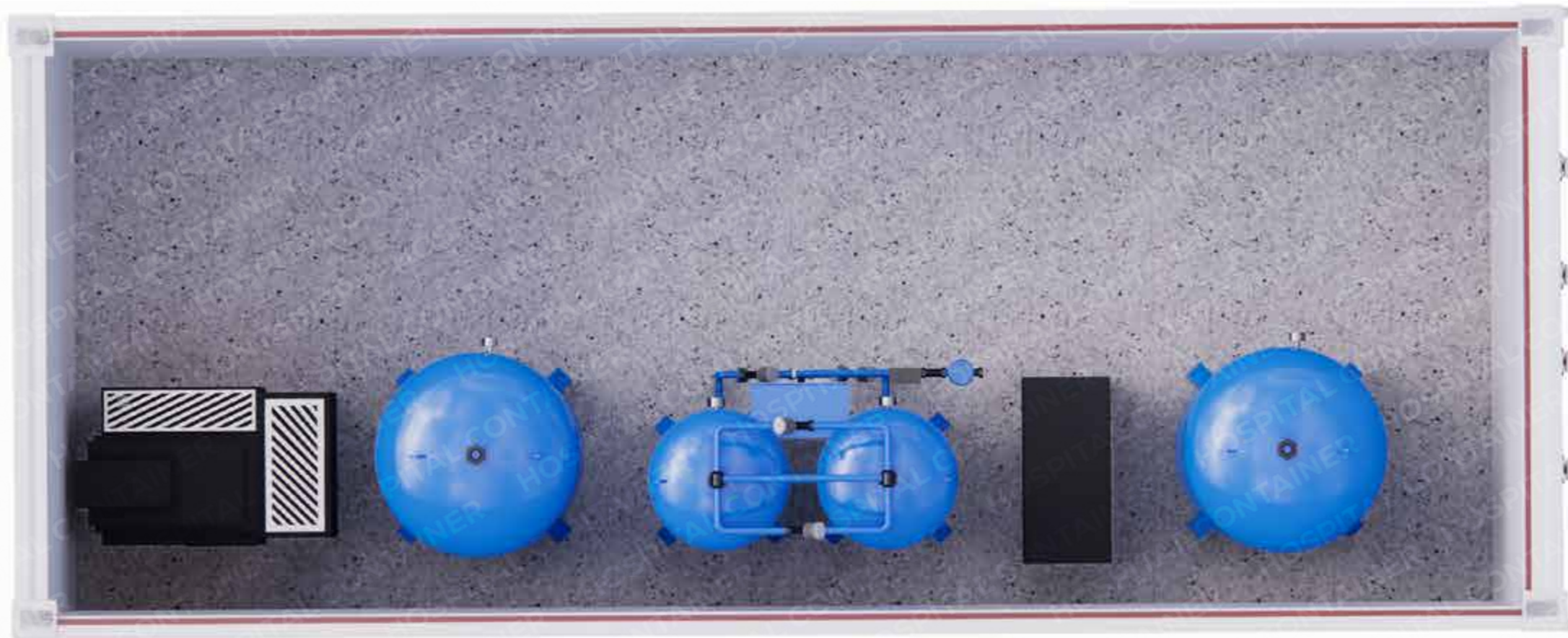

Phone Number  
**+90 216 504 60 64**

Email Address  
**info@hospitalcontainer.com**

Website  
**www.hospitalcontainer.com**

